

RAIN WATER COLLECTION SYSTEM

NOONU KUDAFARI Rozameed Site

June 2017

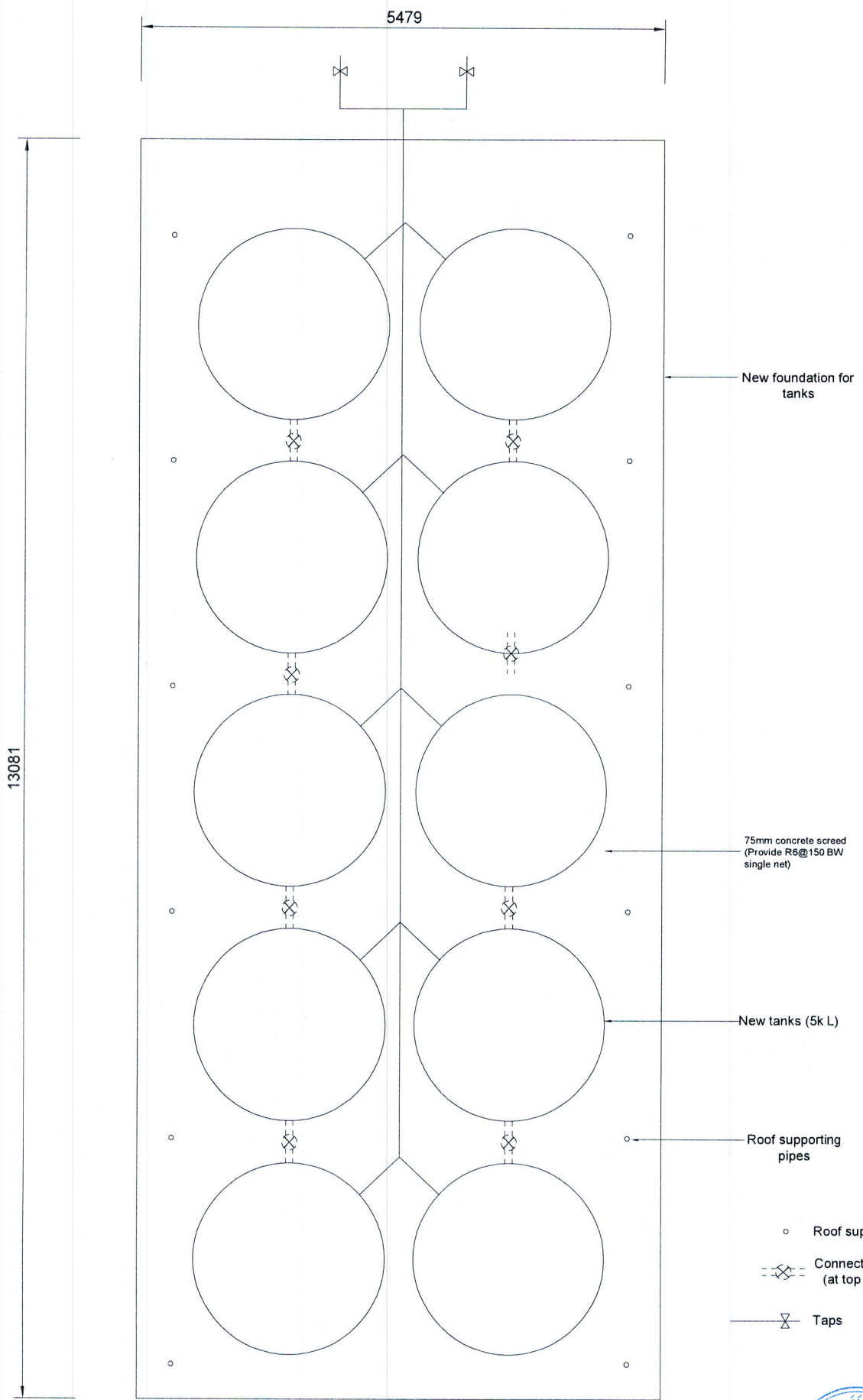



WATER TANK ARRANGEMENT - PLAN
ROZAMEED SITE



4769

2350
2350
2350
2350
2350
2350

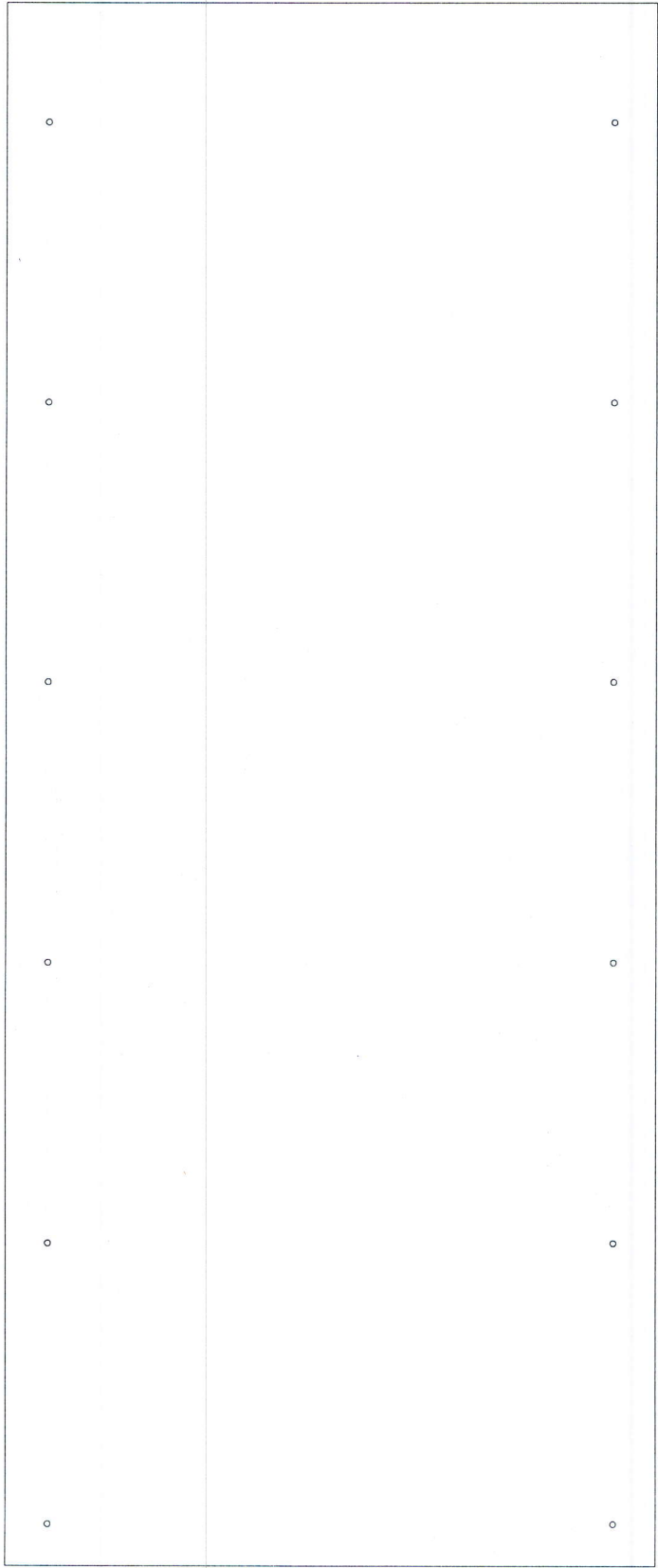

ROOF SUPPORTING PIPE ARRANGEMENT - PLAN
ROZAMEED SITE



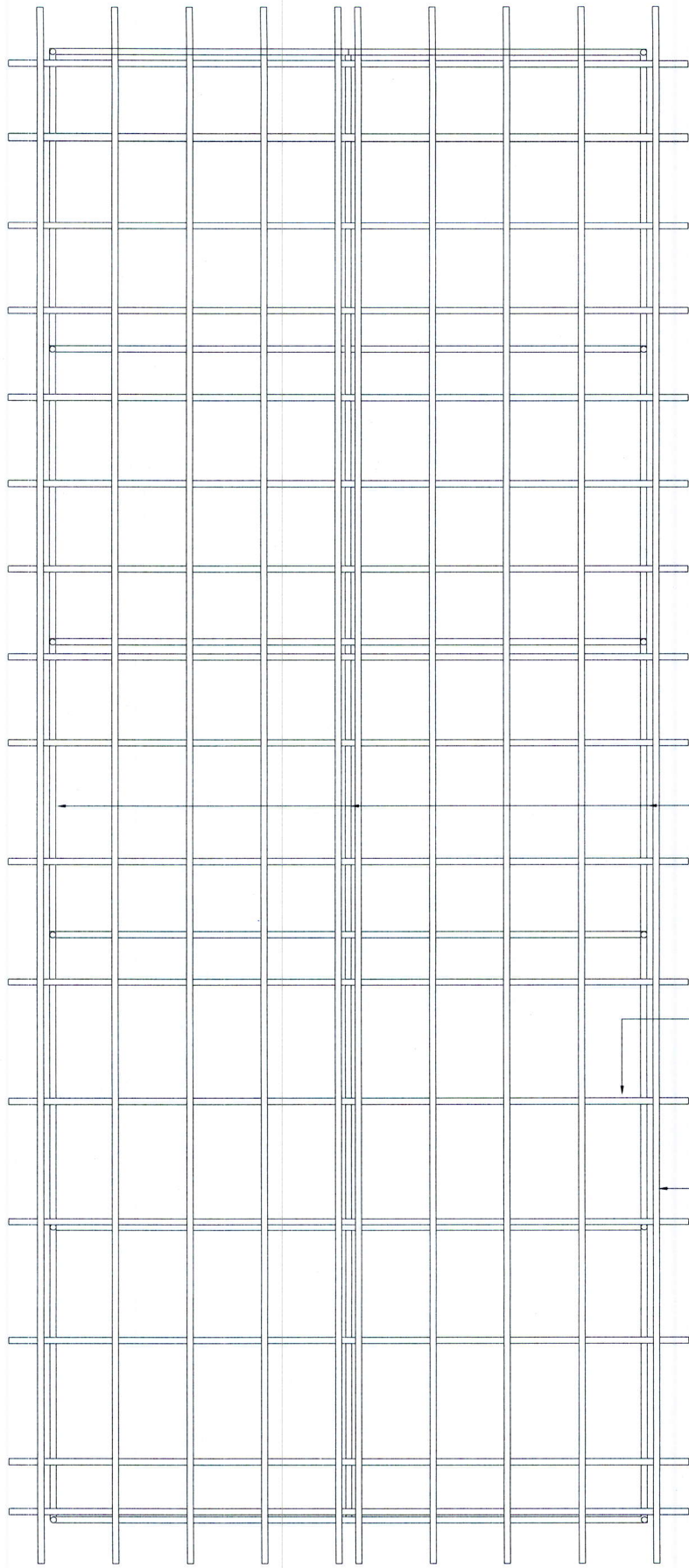

50mmØ G.I pipe
between frames

100x50 Timber
rafters @ 1000 c/c

50x38 Timber
battens @ 600c/c

ROOF FRAMING PLAN
ROZAMEED SITE



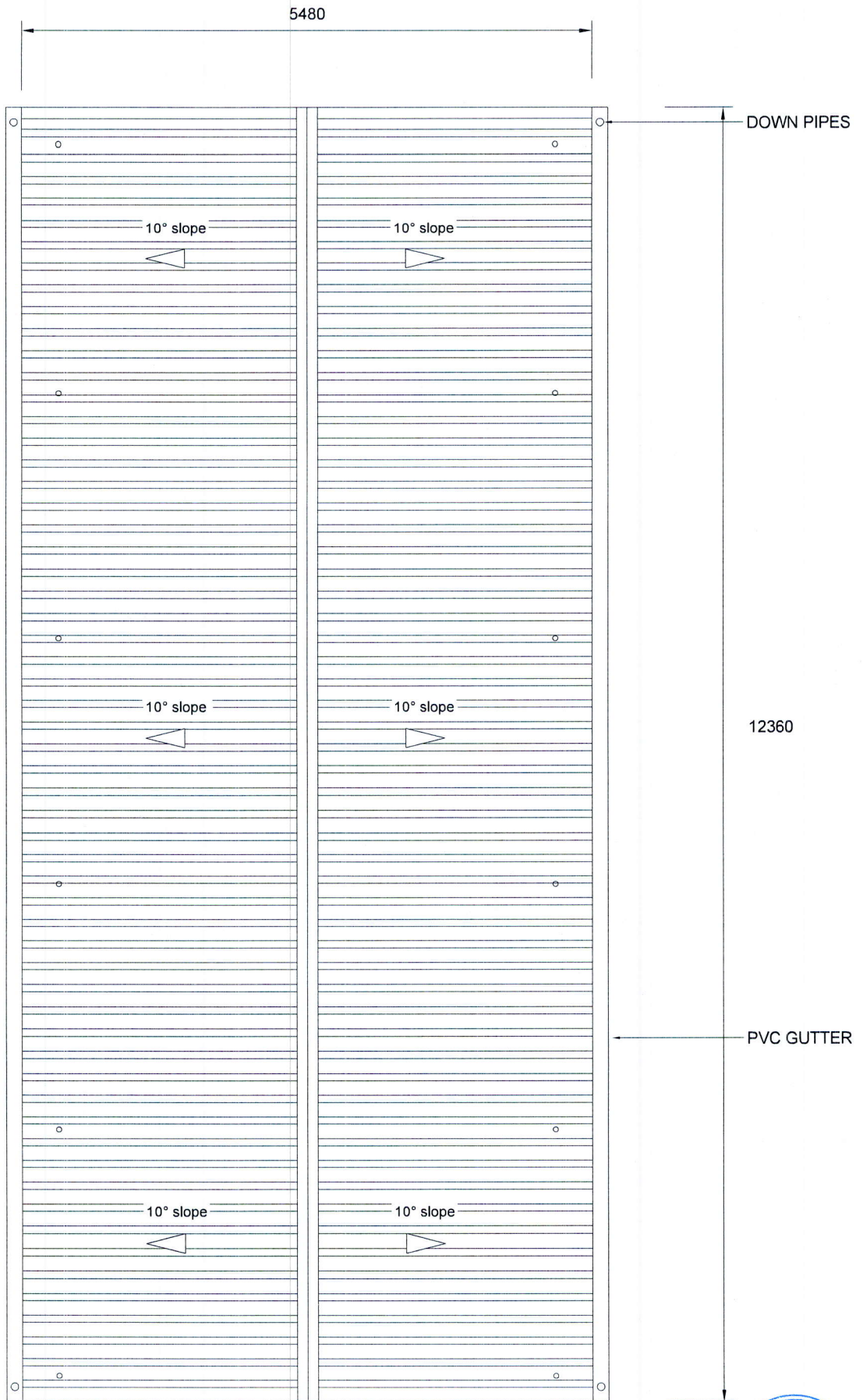

ROOF PLAN OVER WATER TANKS
ROZAMEED SITE



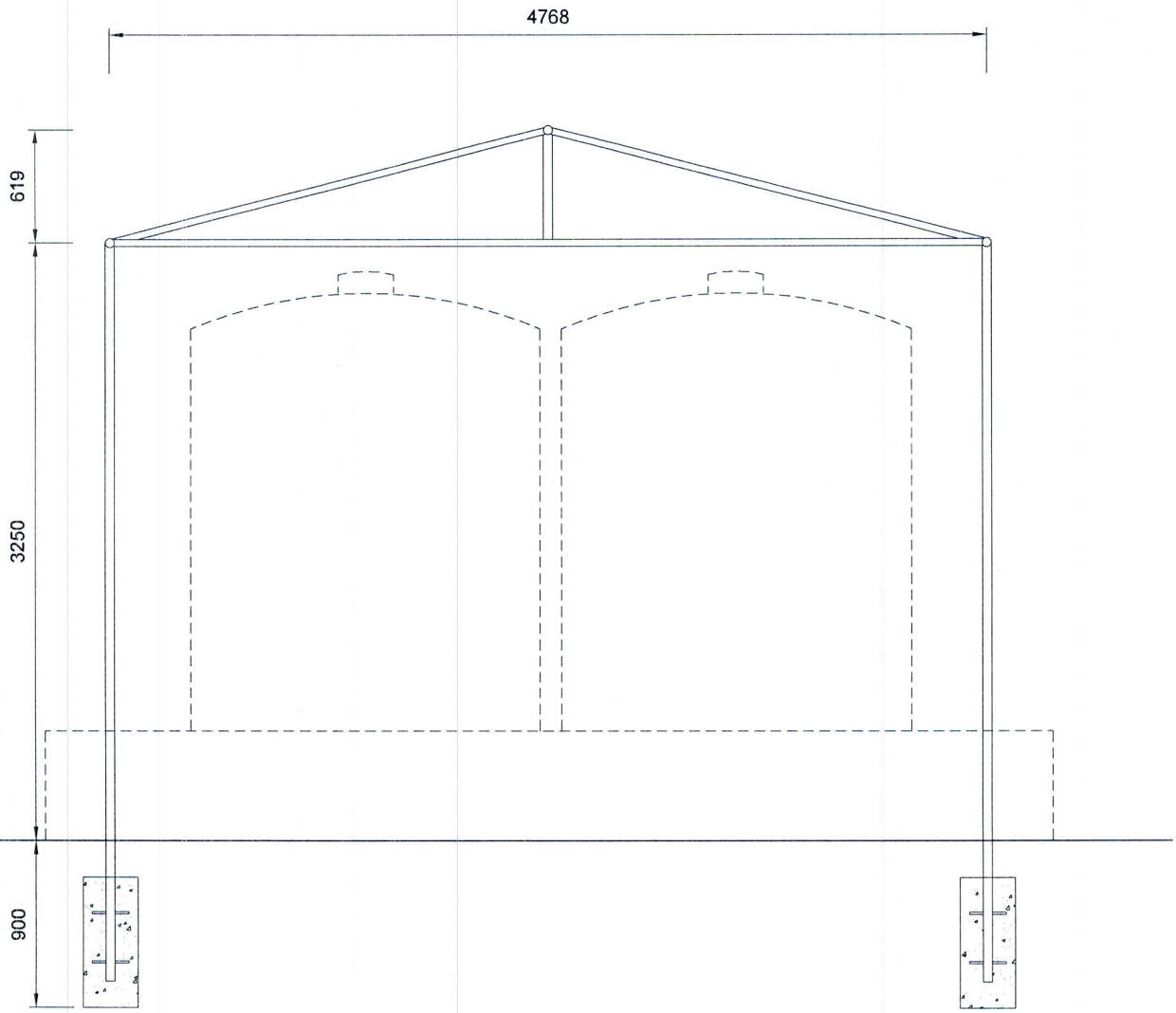

ROOF SUPPORTING FRAME DETAIL
ROZAMEED SITE

- 50mmØ G.I pipe frames
- All welds are 5mm fillet welds



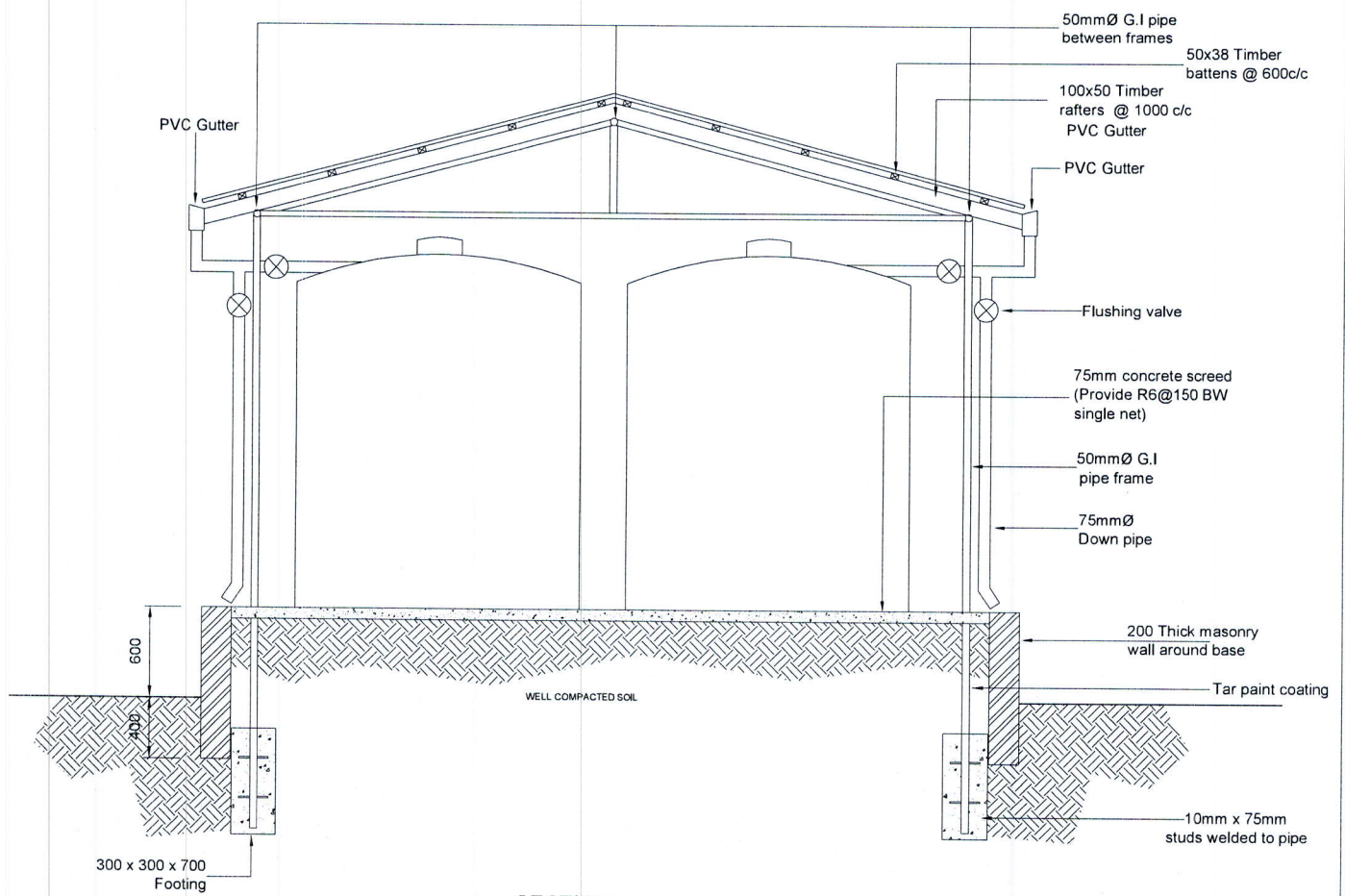

SECTION
ROZAMEED SITE

 Hessa Mohamed

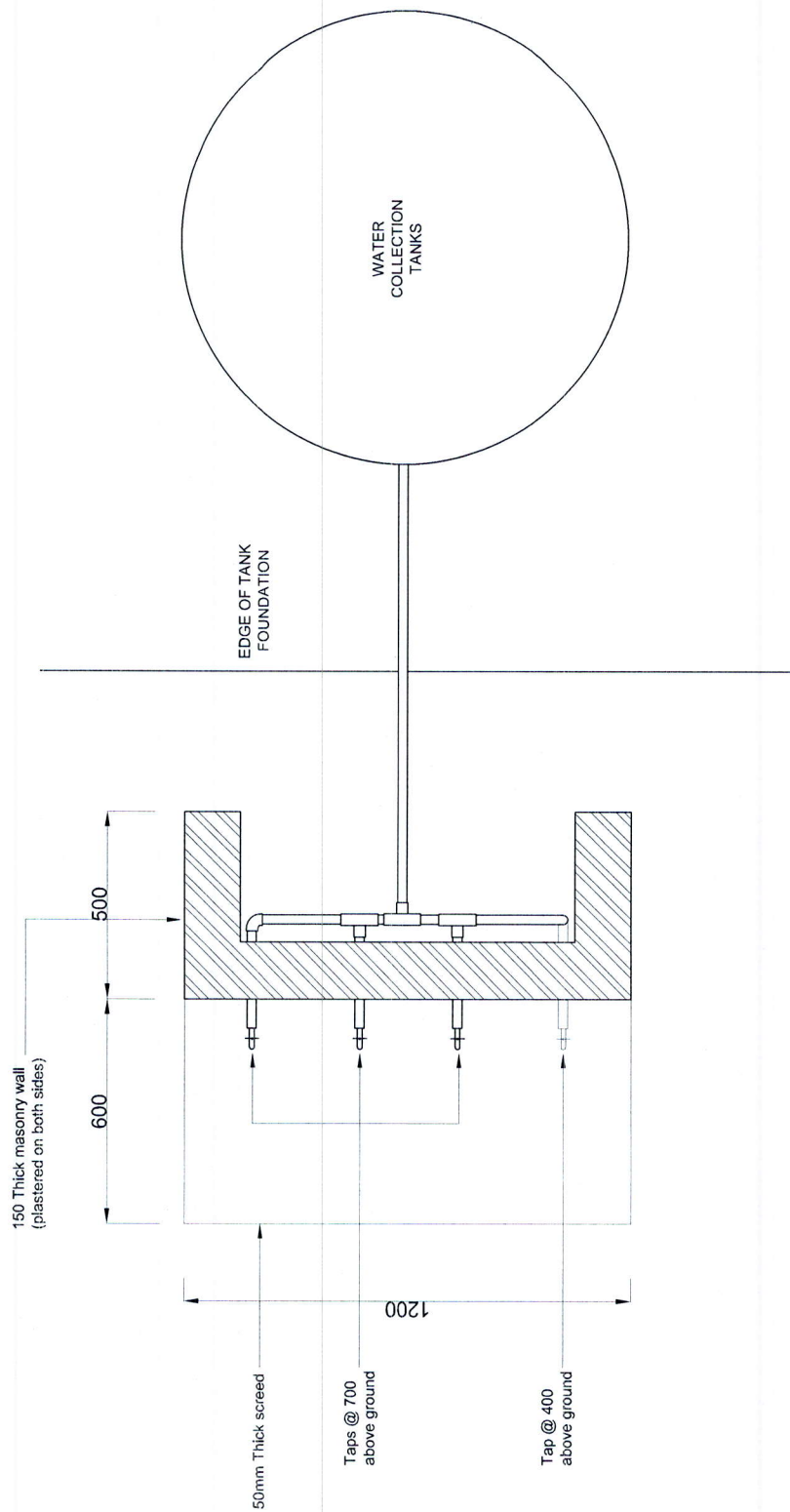

WATER DISTRIBUTION TAPPING STATION
PLAN

Hasnain Khan

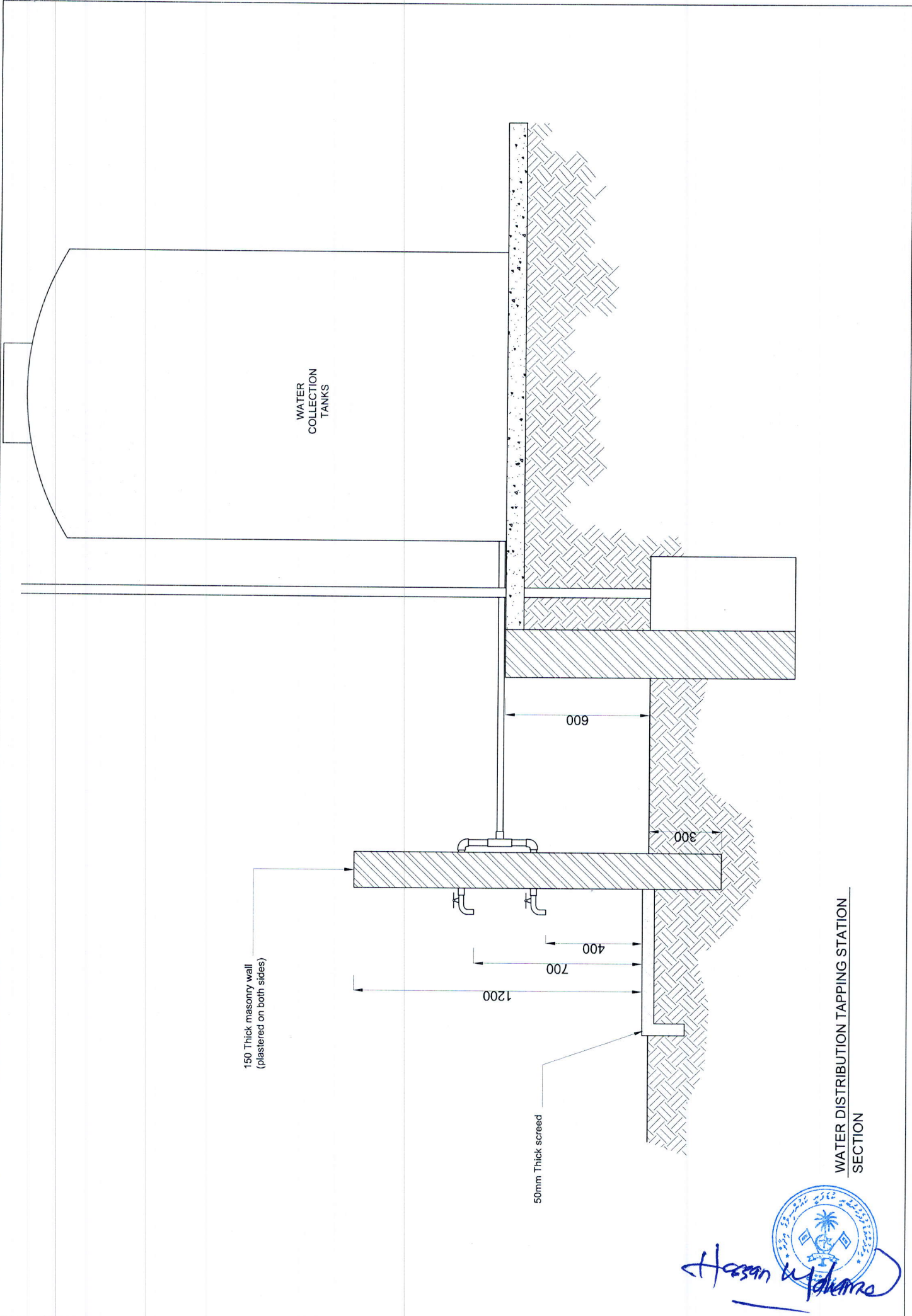

WATER
COLLECTION
TANKS

150 Thick masonry wall
(plastered on both sides)

50mm Thick screed

600

300

400

700

1200

WATER DISTRIBUTION TAPPING STATION
SECTION

Hasan & Partners



RAIN WATER COLLECTION SYSTEM

NOONU KUDAFARI
Thibikaashi Gus Site

December 2017



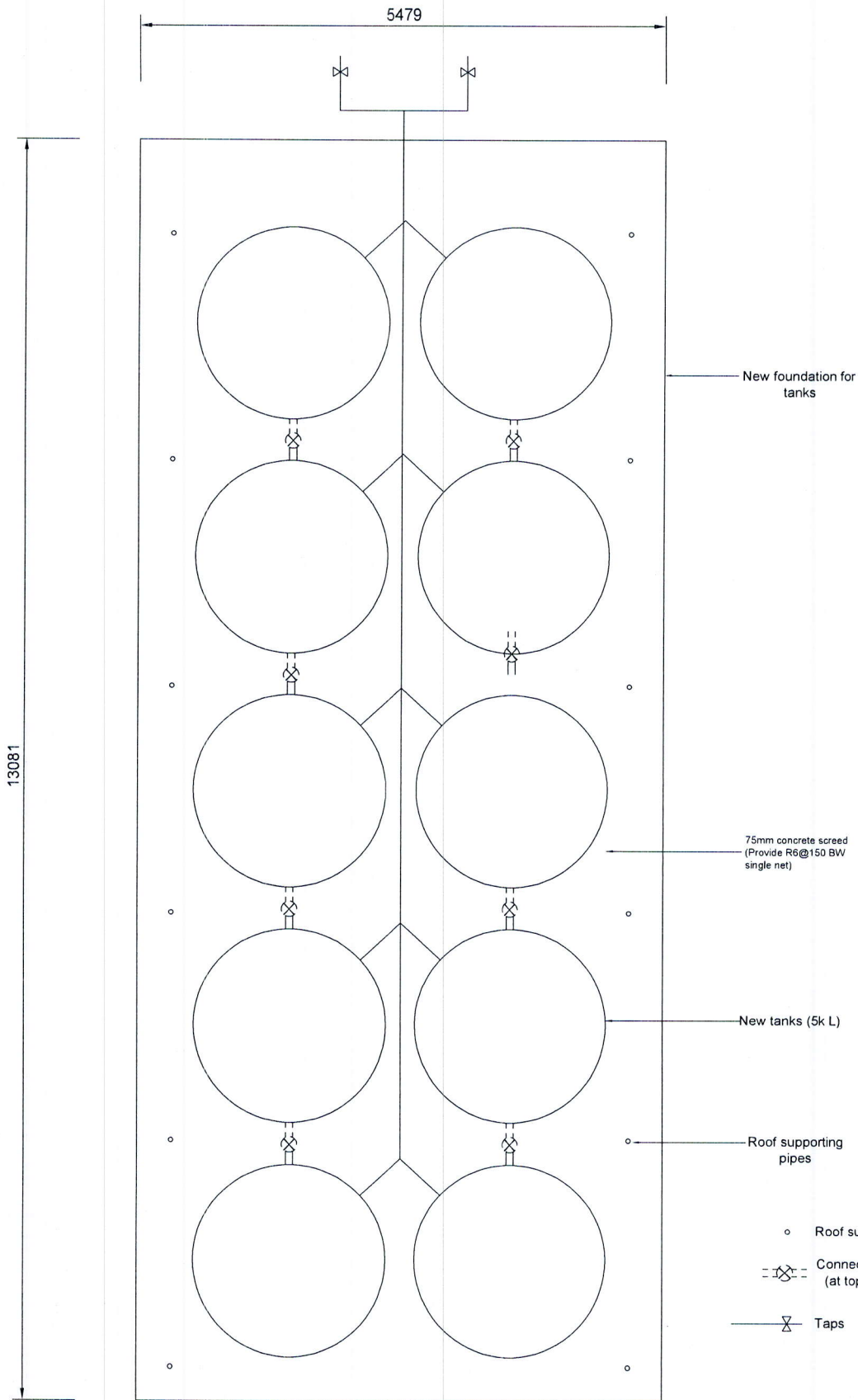

WATER TANK ARRANGEMENT - PLAN
THIBIKAASHI GUS SITE

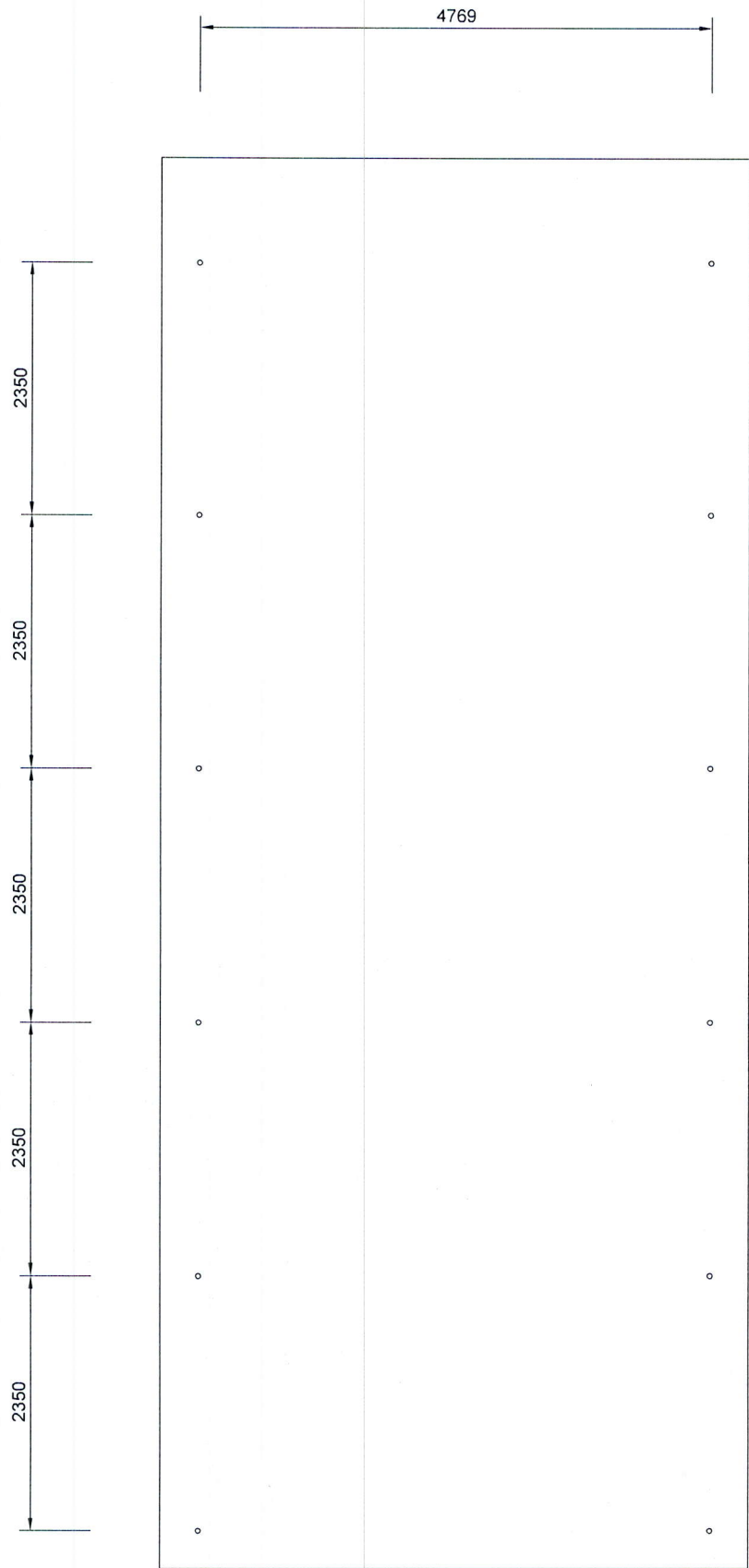

 Hassan Mohamed



ROOF SUPPORTING PIPE ARRANGEMENT - PLAN
THIBIKAASHI GUS SITE

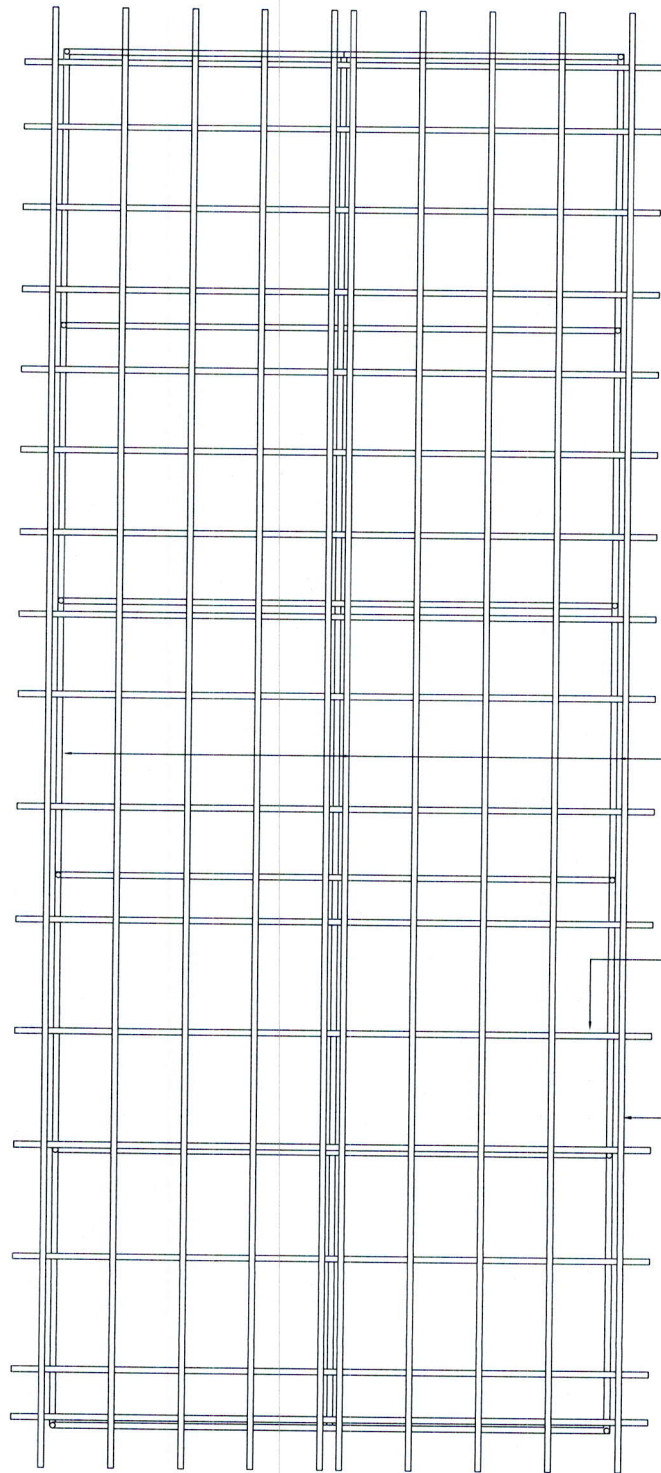

Hassan Mohamed



50mmØ G.I pipe
between frames

100x50 Timber
rafters @ 1000 c/c

50x38 Timber
battens @ 600c/c

ROOF FRAMING PLAN
THIBIKAASHI GUS SITE

Hassan Mohamed

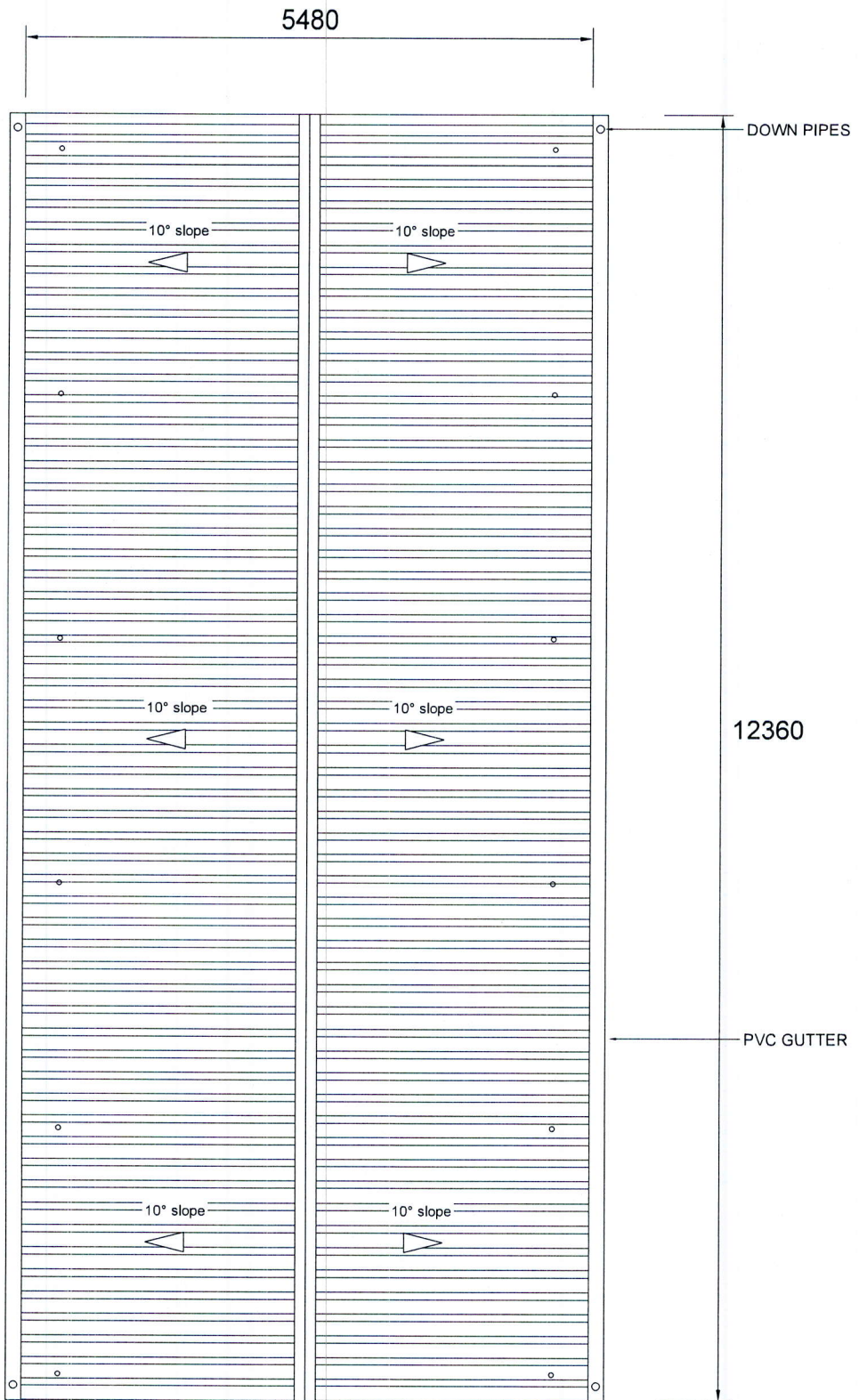
ROOF PLAN OVER WATER TANKS
 THIBIKAASHI GUS SITE

Hasan Yildirim

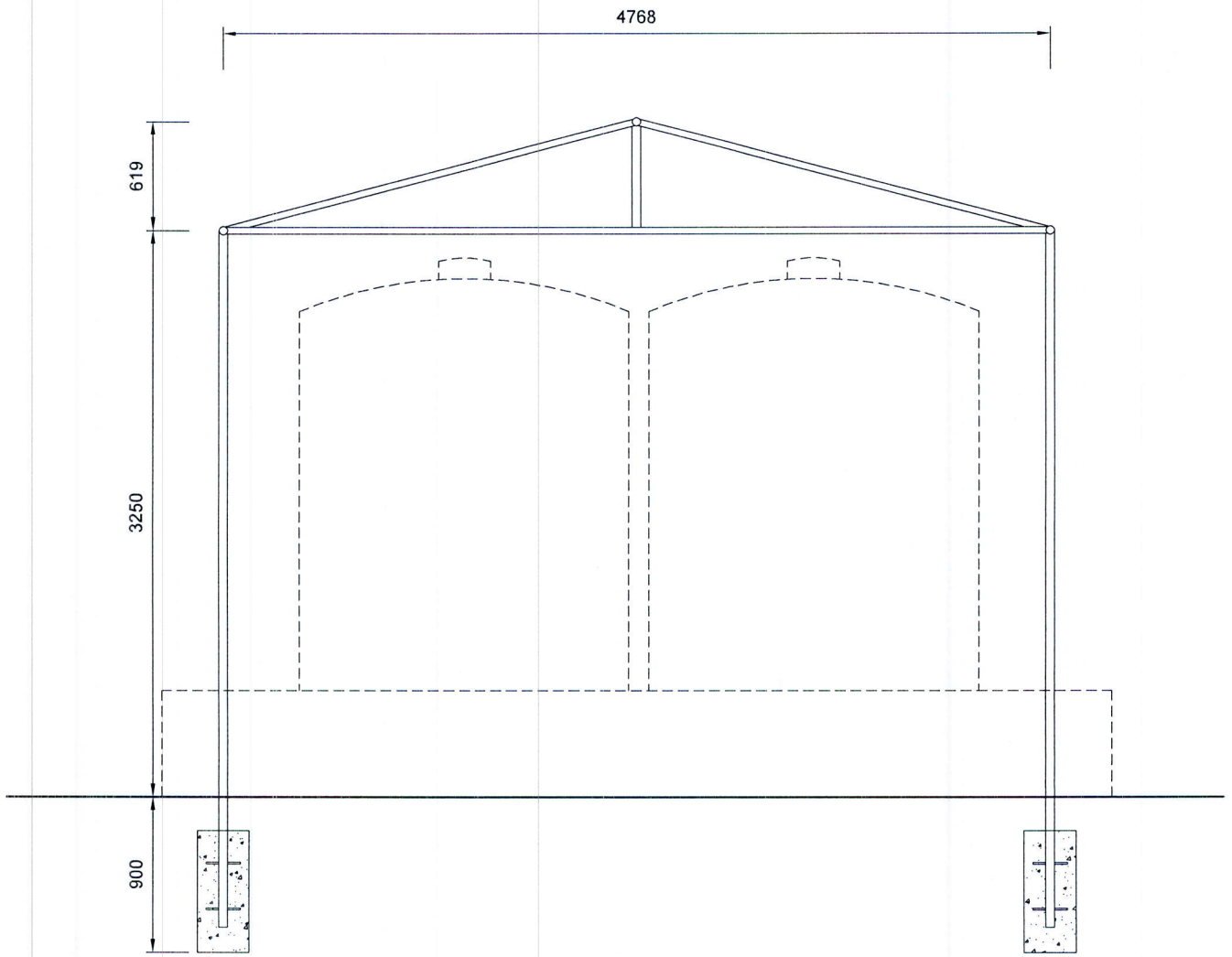

ROOF SUPPORTING FRAME DETAIL
 THIBIKAASHI GUS SITE

- 50mmØ G.I pipe frames
- All welds are 5mm fillet welds

Hassan Mohamed



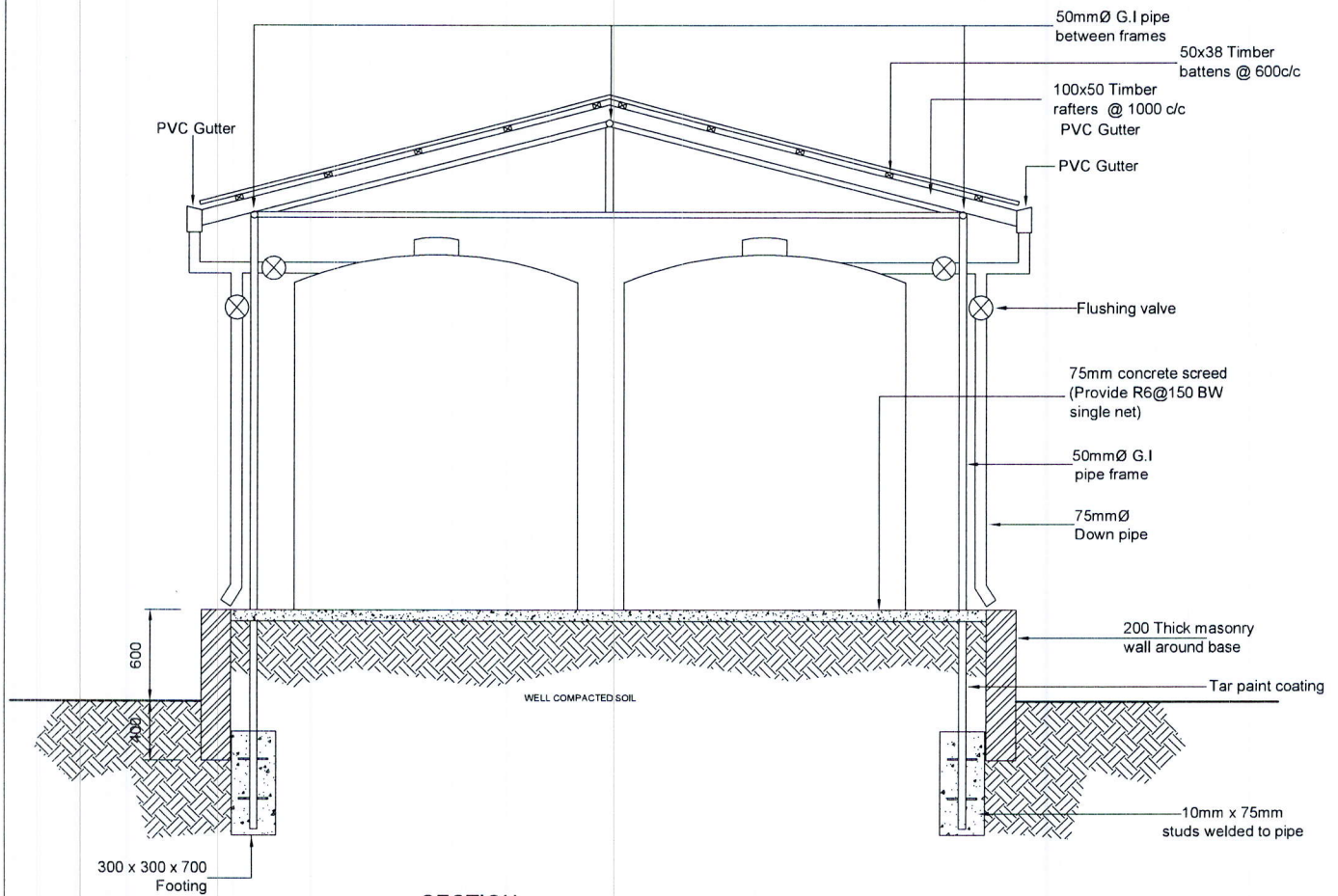

SECTION
 THIBIKAASHI GUS SITE

 Hassan A. Hameed

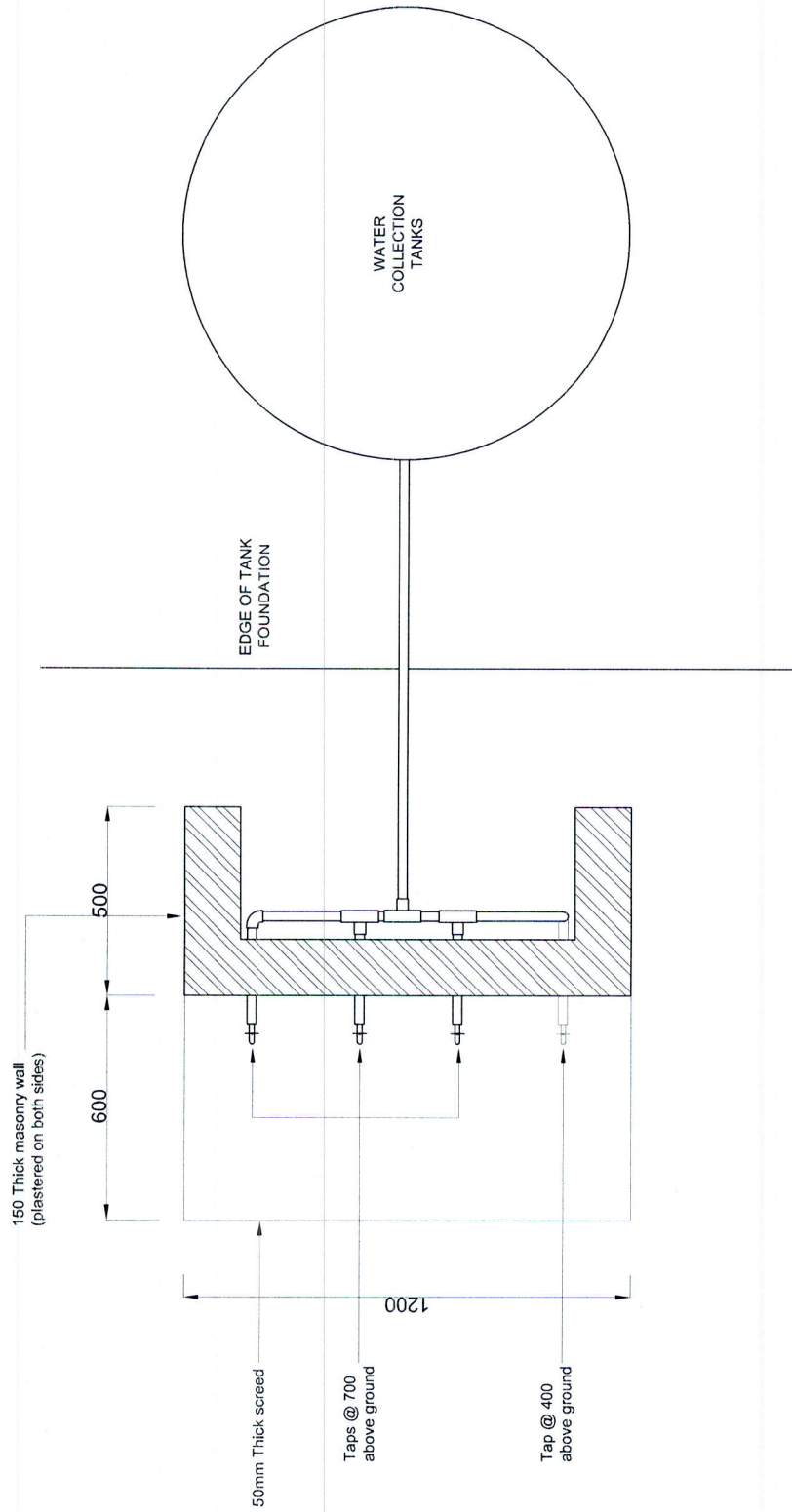

WATER DISTRIBUTION TAPPING STATION
PLAN

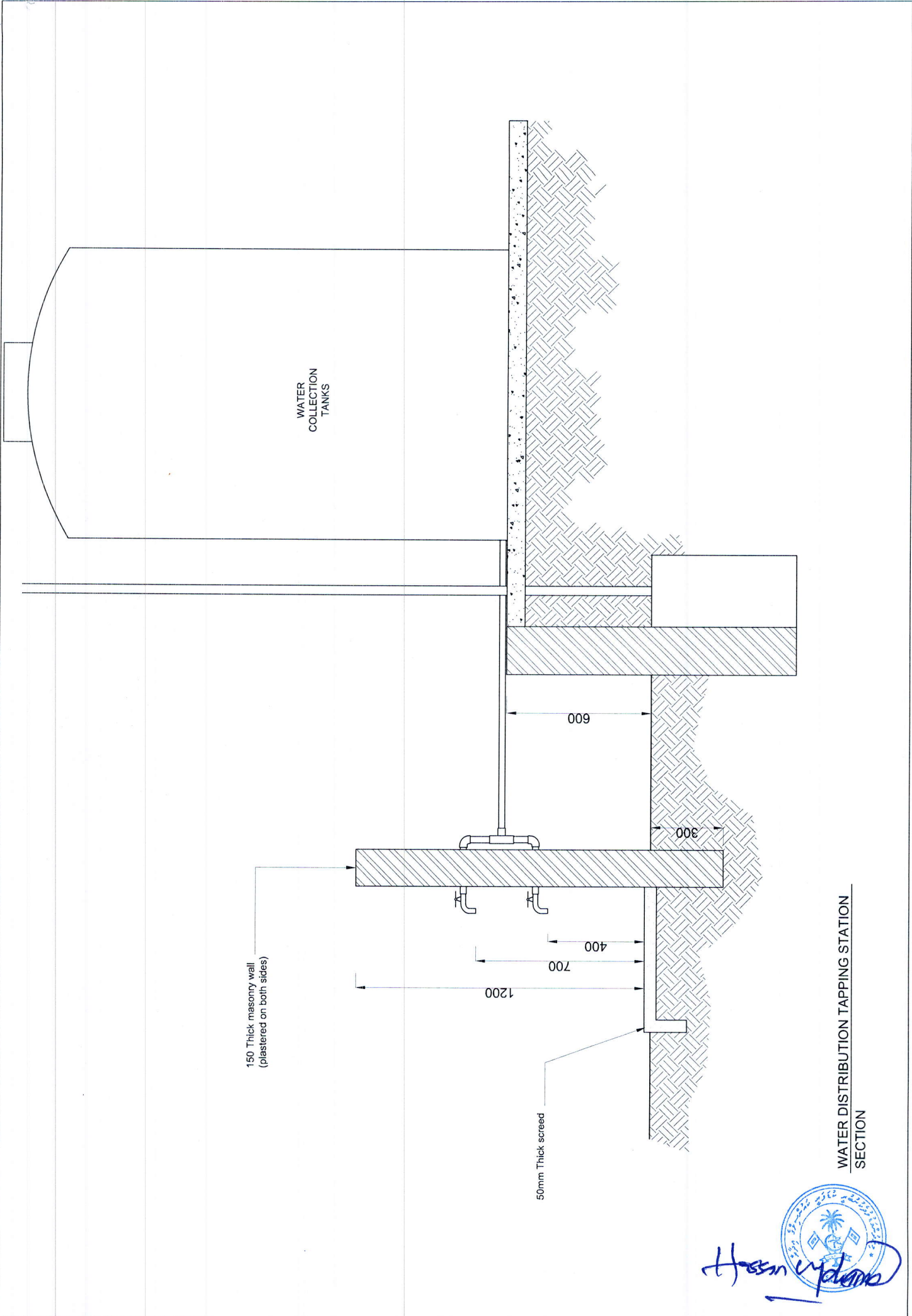

WATER
COLLECTION
TANKS

150 Thick masonry wall
(plastered on both sides)

50mm Thick screed

600

300

1200

700

400

WATER DISTRIBUTION TAPPING STATION
SECTION



CONSTRUCTION OF RAIN WATER HARVESTING FACILITY - N. KUDAFARI
Bill of Quantities

No	Item	Unit	Quantity	Rate	Amount
1	PRELIMINARIES				
1.1	Mobilization to site	LS	1		
1.2	Site management cost including set up of tempory services for contractor's services as maybe necessary	Months			
1.3	Setup sign board on site	LS	1		
1.4	Clean up site upon completion of works	LS	1		
1.5	Demobilization	LS	1		
2	SITE CLEARANCE				
2.1	Allow for all site clean up work including relocation of any existing material to waste yard of island	LS	1		
3	EARTH WORKS				
	Rozameed site				
3.1	Excavation work for perimeter foundation wall	m3	2.98		
3.2	Excavation for pole footings	m3	0.97		
3.3	Filling of foundation pad with soil	m3	43.02		
3.4	Levelling of filled soil to cast slab	m2	71.70		
	Thibikaashi Gus Site				
3.5	Excavation work for perimeter foundation wall	m3	2.98		
3.6	Excavation for pole footings	m3	0.97		
3.7	Filling of foundation pad with soil	m3	43.02		
3.8	Levelling of filled soil to cast slab	m2	71.70		
4	CONCRETE WORKS				
	Rozameed site				
4.1	Casting of 75mm concrere screed over compacted sand. Rate shall include provision of damp proof membrane	m3	5.38		
4.2	Casting of concrete footings for shed columns	m3	0.76		
	Thibikaashi Gus Site				
4.3	Casting of 75mm concrere screed over compacted sand. Rate shall include provision of damp proof membrane	m3	5.38		
4.4	Casting of concrete footings for shed columns	m3	0.76		
5	MASONRY WORKS				
	Rozameed site				
5.1	1000mm high wall for perimeter foundation wall	m	37.1		
	Thibikaashi Gus Site				
5.2	1000mm high wall for perimeter foundation wall	m	37.1		
6	PLASTERING WORKS				
	Rozameed site				
6.1	25mm plastering on perimeter foundation wall	m2	74.2		



	Thibikaashi Gus Site				
6.2	25mm plastering on perimeter foundation wall	m2	74.2		
7	ROOFING WORKS				
	Rozameed site				
7.1	Lysaght roofing sheet for collection bay area. Rate shall include all necessary laps, fastening, fixtures and sealing of joints	m2	70.452		
7.2	Timber rafters - 100 x 50mm. Rate shall include for all fixing and joints	m	91.20		
7.3	Timber battens - 50 x 38mm. Rate shall include for all fixing and joints.	m	124.00		
7.4	Installation of gutter on both sides of roof	m	24.72		
7.5	Installation of down pipes.	Nos	4.00		
	Thibikaashi Gus Site				
7.6	Lysaght roofing sheet for collection bay area. Rate shall include all necessary laps, fastening, fixtures and sealing of joints	m2	70.452		
7.7	Timber rafters - 100 x 50mm. Rate shall include for all fixing and joints	m	91.20		
7.8	Timber battens - 50 x 38mm. Rate shall include for all fixing and joints.	m	124.00		
7.9	Installation of gutter on both sides of roof	m	24.72		
7.10	Installation of down pipes.	Nos	4.00		
8	STRUCTURAL STEEL WORKS				
	Rozameed site				
8.1	Fabricate and install roof supporting frames made from 50mm G.I pipes. Rate shall include all cuts, welds and applying oxide coating on the welds	nos	6		
8.2	Fixing 50mm G.I pipes between pipes at roof level to provide overall support	m	35.1		
8.3	Welding of studs to base of pipes	LS	1		
	Thibikaashi Gus Site				
8.4	Fabricate and install roof supporting frames made from 50mm G.I pipes. Rate shall include all cuts, welds and applying oxide coating on the welds	nos	6		
8.5	Fixing 50mm G.I pipes between pipes at roof level to provide overall support	m	35.1		
8.6	Welding of studs to base of pipes	LS	1		
9	PLUMBING WORKS				
	Rozameed site				
9.1	Provide connection from gutter to collection tank. Rate shall include all necessary pipes, bends, fittings and valves and others as maybe required.	LS	1		
9.2	Provide 5000 L tank to site and install as shown on drawing	No	10		
9.3	Provide connections to top of tank for filling of tanks and provide connections to base of tank for collection of tank from base	LS	1		



9.4	Construct and setup water tap bay as shown on drawing and provide all connections from tank to tap bay	LS	1		
Thibikaashi Gus Site					
9.5	Provide connection from gutter to collection rank. Rate shall include all necessary pipes, bends, fittings and valves and others as maybe required.	LS	1		
9.6	Provide 5000 L tank to site and install as shown on drawing	No	10		
9.7	Provide connections to top of tank for filling of tanks and provide connections to base of tank for collection of tank from base	LS	1		
9.8	Construct and setup water tap bay as shown on drawing and provide all connections from tank to tap bay	LS	1		
10	OTHERS				
10.1	Applying paint coating on all steel members including tar paint for surfaces below ground level	LS	1		
10.2	Provide cover blocks to hold reinforcement in place	LS	1		

TOTAL



 Hessa Municipality