

# **RAIN WATER COLLECTION SYSTEM**

**BAA FULHADHOO**

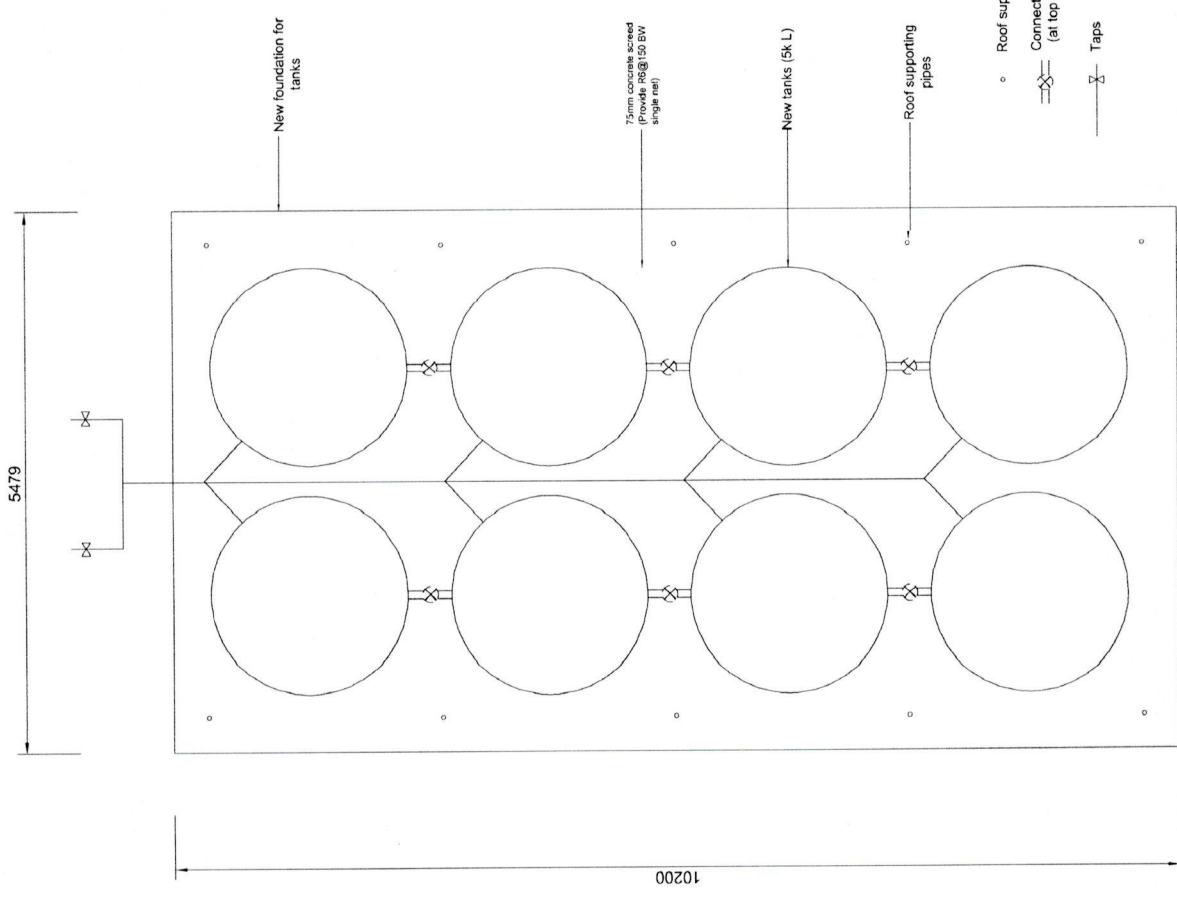

**October 2017**



WATER TANK ARRANGEMENT - PLAN  
 UJHIMAAEE SITE



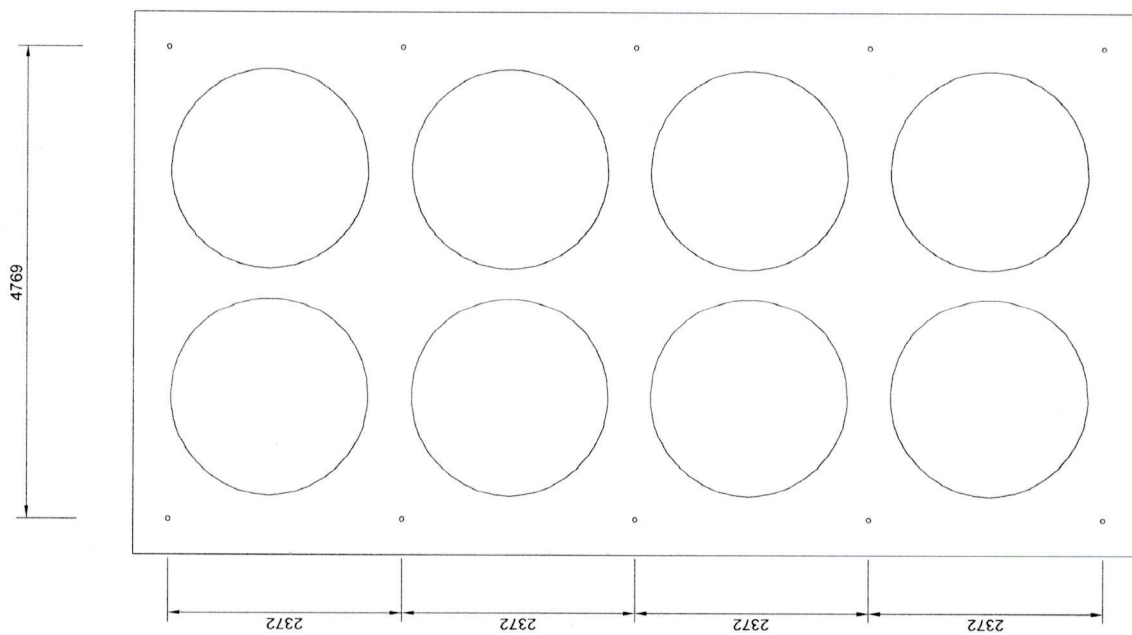

ROOF SUPPORTING PIPE ARRANGEMENT - PLAN  
DITHIMAAEE SITE



*Handwritten signature*

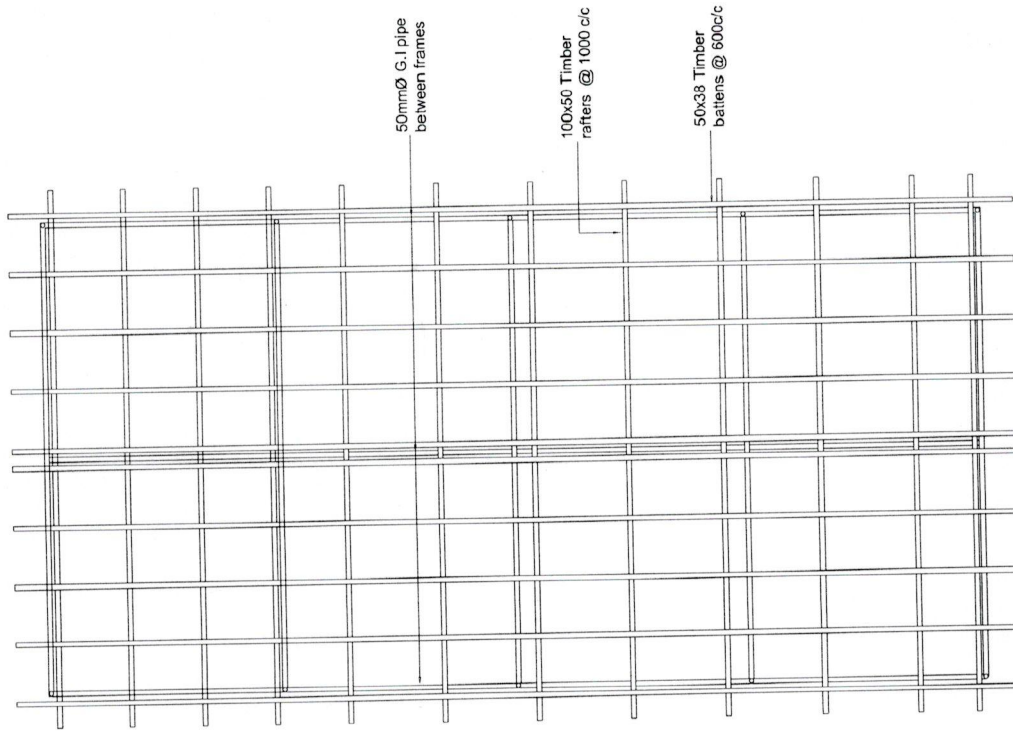

50mm Ø G.I pipe  
between frames

100x50 Timber  
rafters @ 1000 c/c

50x38 Timber  
battens @ 600c/c

ROOF FRAMING PLAN  
LITHIMAAEE SITE



*[Handwritten signature]*



ROOF PLAN OVER WATER TANKS  
 TUTHIMAAEE SITE



*[Handwritten signature]*

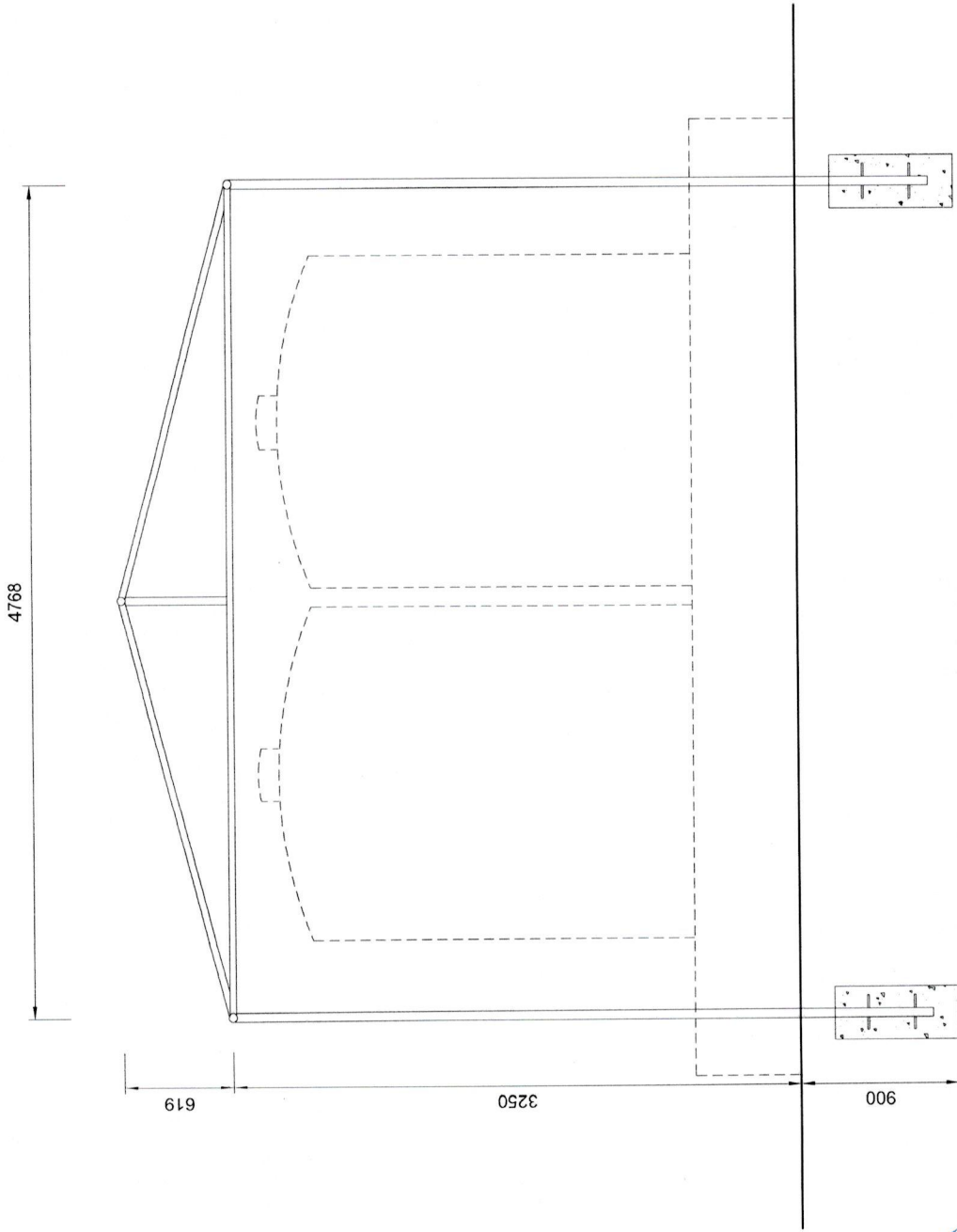

- 50mmØ G.I pipe frames
- All welds are 5mm fillet welds

ROOF SUPPORTING FRAME DETAIL  
IJTHIMAAEE SITE



*[Handwritten signature]*

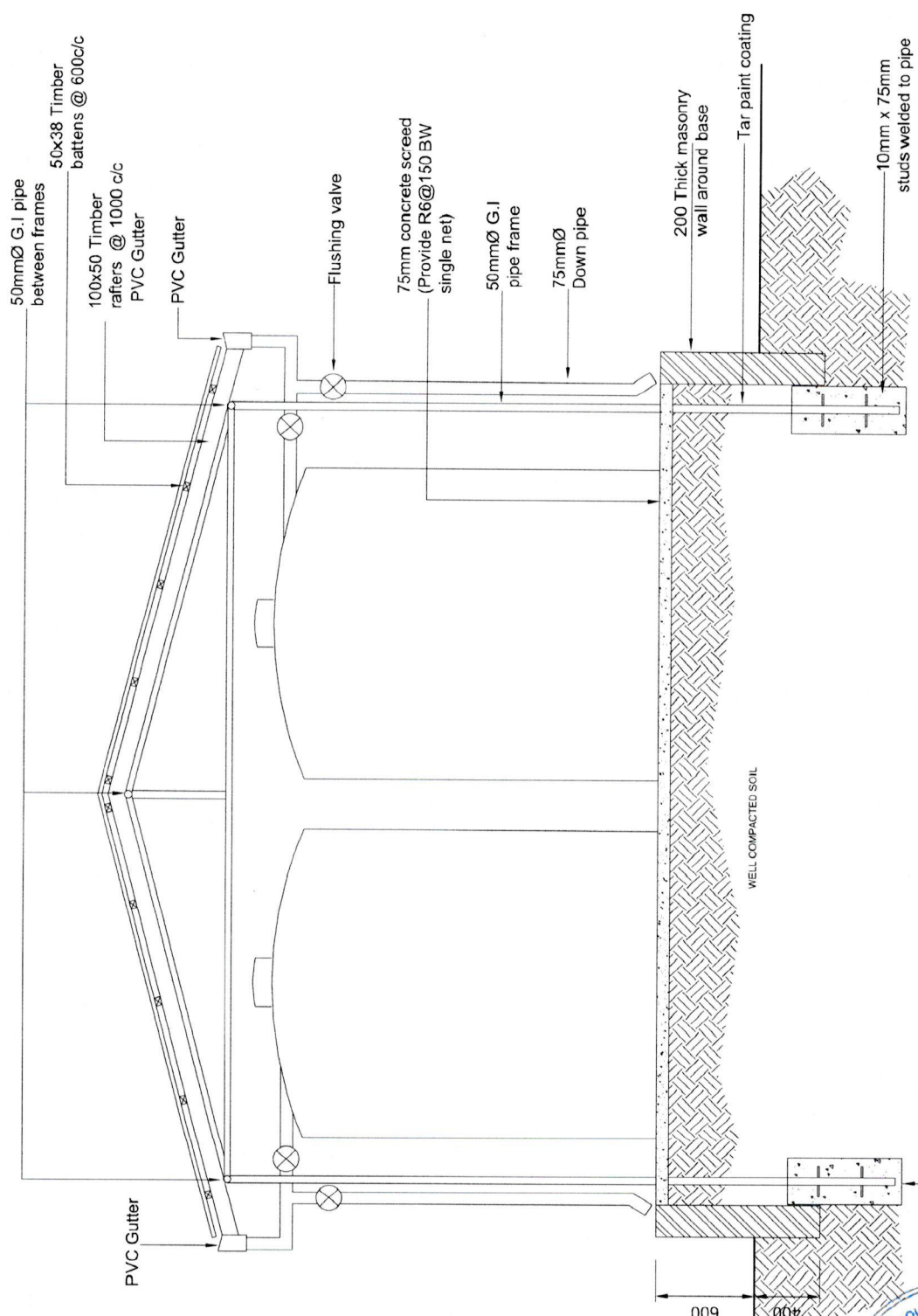

SECTION  
IUTHIMAAEE SITE



*[Handwritten signature]*

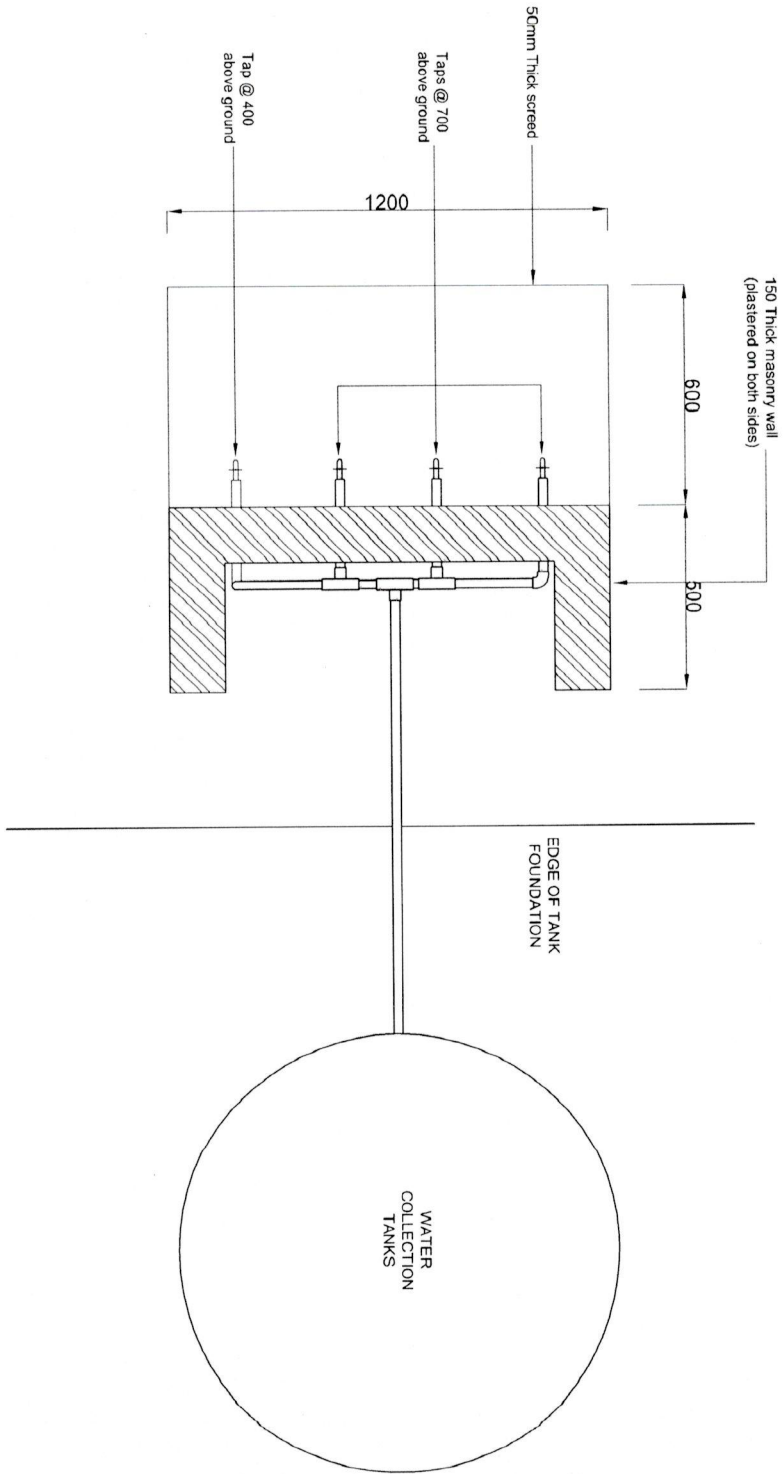

WATER DISTRIBUTION TAPPING STATION  
PLAN



*Handwritten signature*





*Handwritten signature*

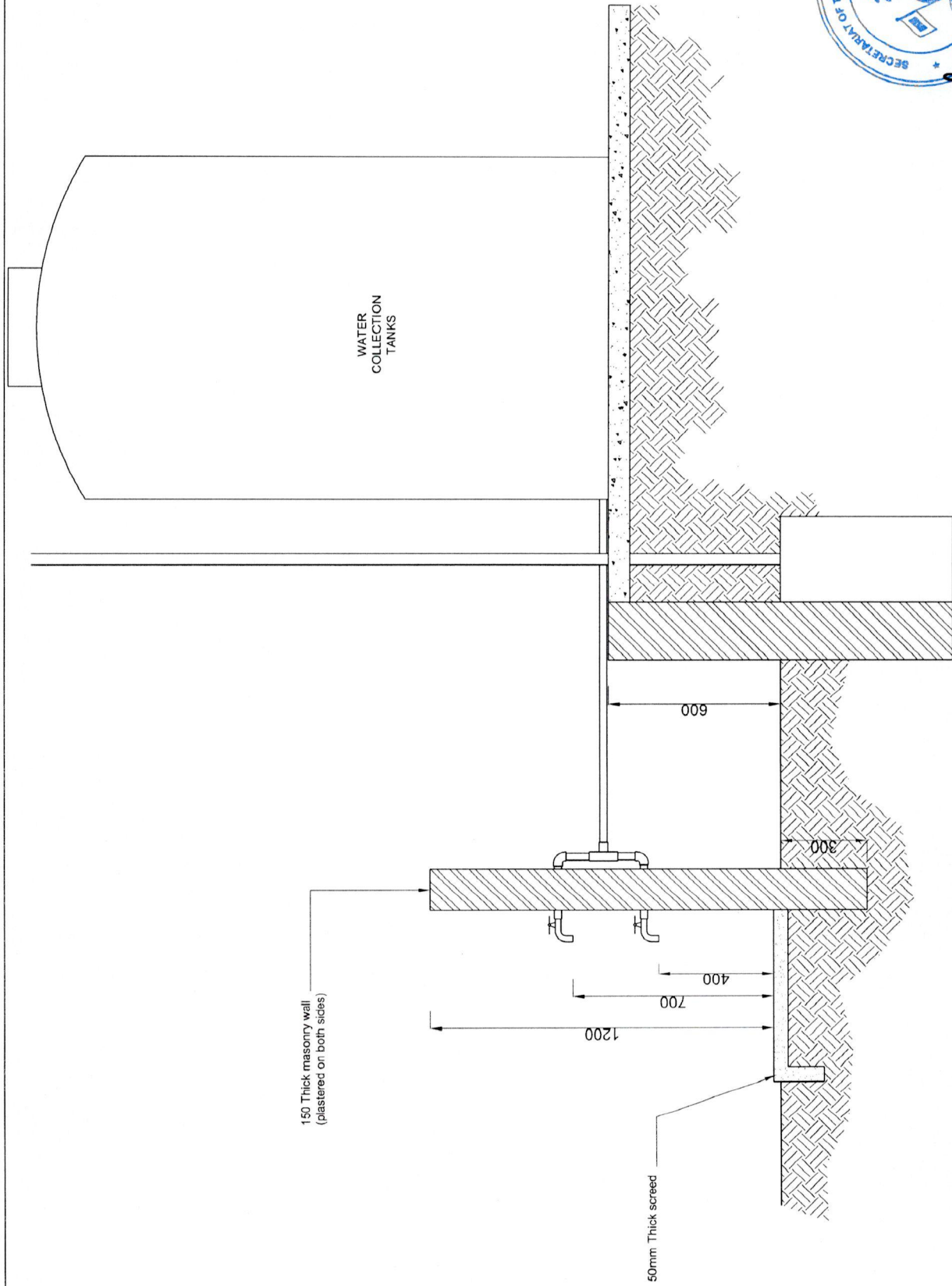

WATER DISTRIBUTION TAPPING STATION  
SECTION

**CONSTRUCTION OF RAIN WATER HARVESTING FACILITY - B. FULHADHOO**

**Bill of Quantities**

No	Item	Unit	Quantity	Rate	Amount
<b>1</b>	<b>PRELIMINARIES</b>				
1.1	Mobilization to site	LS	1		
1.2	Site management cost including set up of temporary services for contractor's services as maybe necessary	Months			
1.3	Setup sign board on site	LS	1		
1.4	Clean up site upon completion of works	LS	1		
1.5	Demobilization	LS	1		
<b>2</b>	<b>SITE CLEARANCE</b>				
2.1	Allow for all site clean up work including relocation of any existing material to waste yard of island	LS	1		
<b>3</b>	<b>EARTH WORKS</b>				
3.1	Excavation work for perimeter foundation wall	m3	2.50		
3.2	Excavation for pole footings	m3	0.81		
3.3	Filling of foundation pad with soil	m3	33.54		
3.4	Levelling of filled soil to cast slab	m2	55.90		
<b>4</b>	<b>CONCRETE WORKS</b>				
4.1	Casting of 75mm concrete screed over compacted sand.	m3	4.19		
4.2	Casting of concrete footings for shed columns	m3	0.63		
<b>5</b>	<b>MASONRY WORKS</b>				
5.1	1000mm high wall for perimeter foundation wall	m	31.4		
<b>6</b>	<b>PLASTERING WORKS</b>				
6.1	25mm plastering on perimeter foundation wall	m2	62.8		
<b>7</b>	<b>ROOFING WORKS</b>				
7.1	Lysaght roofing sheet for tank area. Rate shall include all necessary laps, fastening, fixtures and sealing of joints	m2	57.57		
7.2	Timber rafters - 100 x 50mm. Rate shall include for all fixing and joints	m	68.40		
7.3	Timber battens - 50 x 38mm. Rate shall include for all fixing and joints.	m	102.00		
7.4	Installation of gutter on roof	m	20.20		
7.5	Installation of down pipes.	Nos	4.00		
<b>8</b>	<b>STRUCTURAL STEEL WORKS</b>				

*[Handwritten signature]*



8.1	Fabricate and install roof supporting frames made from 50mm G.I pipes. Rate shall include all cuts, welds and applying oxide coating on the welds	nos	5		
8.2	Fixing 50mm G.I pipes between pipes at roof level to provide overall support	m	30.3		
8.3	Welding of studs to base of pipes	LS	1		
<b>9</b>	<b>PLUMBING WORKS</b>				
9.1	Provide connection from gutter to collection tank. Rate shall include all necessary pipes, bends, fittings and valves and others as maybe required.	LS	1		
9.2	Provide 5000 L tank to site and install as shown on drawing	No	8		
9.3	Provide connections to top of tank for filling of tanks and provide connections to base of tank for collection of tank from base	LS	1		
9.4	Construct and setup water tap bay as shown on drawing and provide all connections from tank to tap bay	LS	1		
9.5	Provide connection from roof to water tanks as required	LS	1		
<b>10</b>	<b>OTHERS</b>				
10.1	Applying paint coating on all steel members including tar paint for surfaces below ground level	LS	1		
10.2	Provide damp proof membrane below concrete surfaces of ground slab	m2	55.9		
10.3	Provide cover blocks to hold reinforcement in place	LS	1		
10.4	Setup water tapping station as shown on drawing.	LS	1		

**TOTAL**

*[Handwritten Signature]*

