

Handwritten text in Arabic script, likely a title or reference, located in the top left corner.

RAIN WATER COLLECTION SYSTEM

BAA GOIDHOO

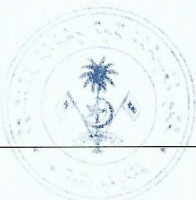

May 2017

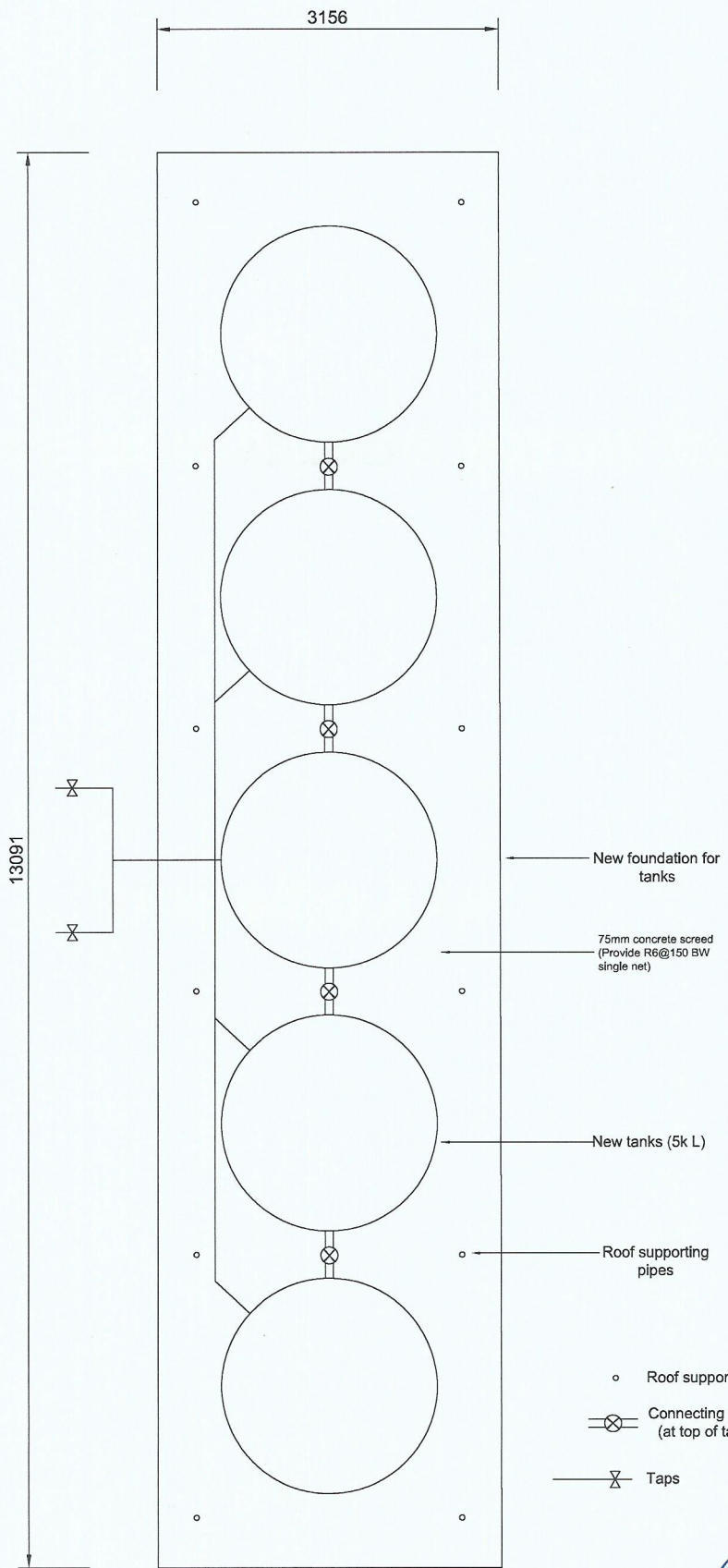

WATER TANK ARRANGEMENT - PLAN
PRESCHOOL SITE

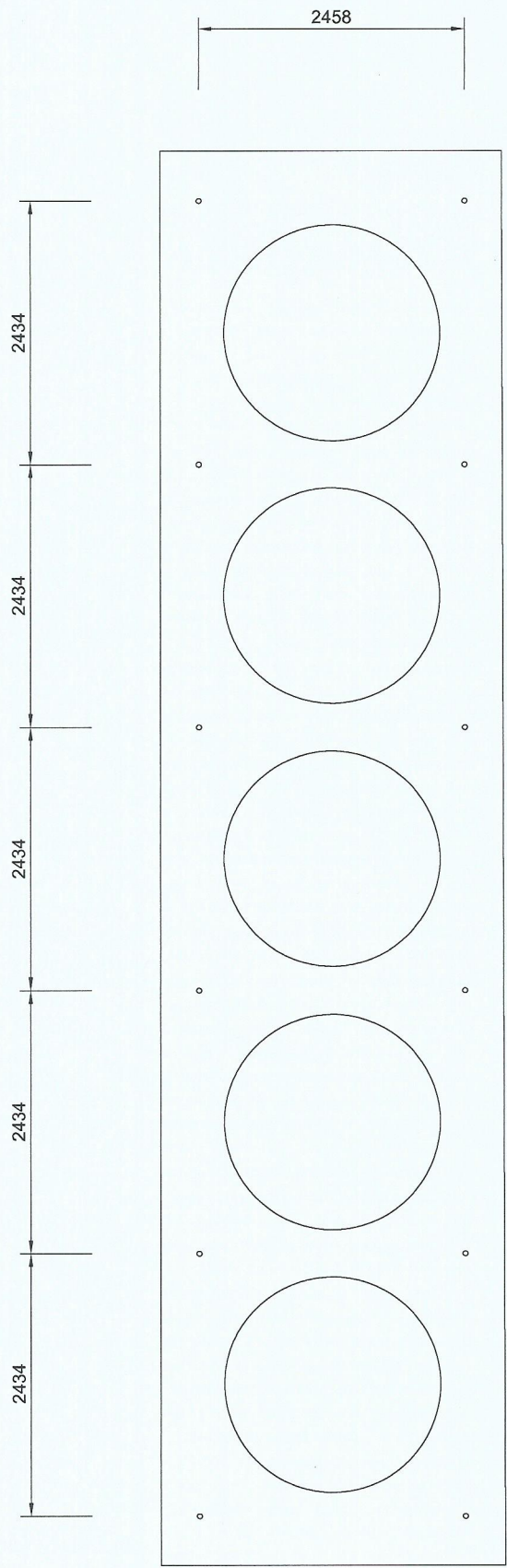

ROOF SUPPORTING PIPE ARRANGEMENT - PLAN
PRESCHOOL SITE

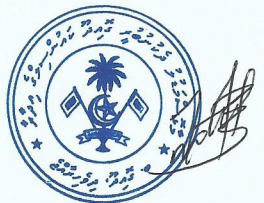
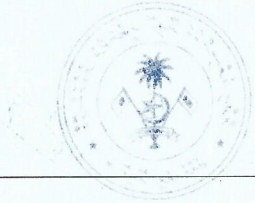

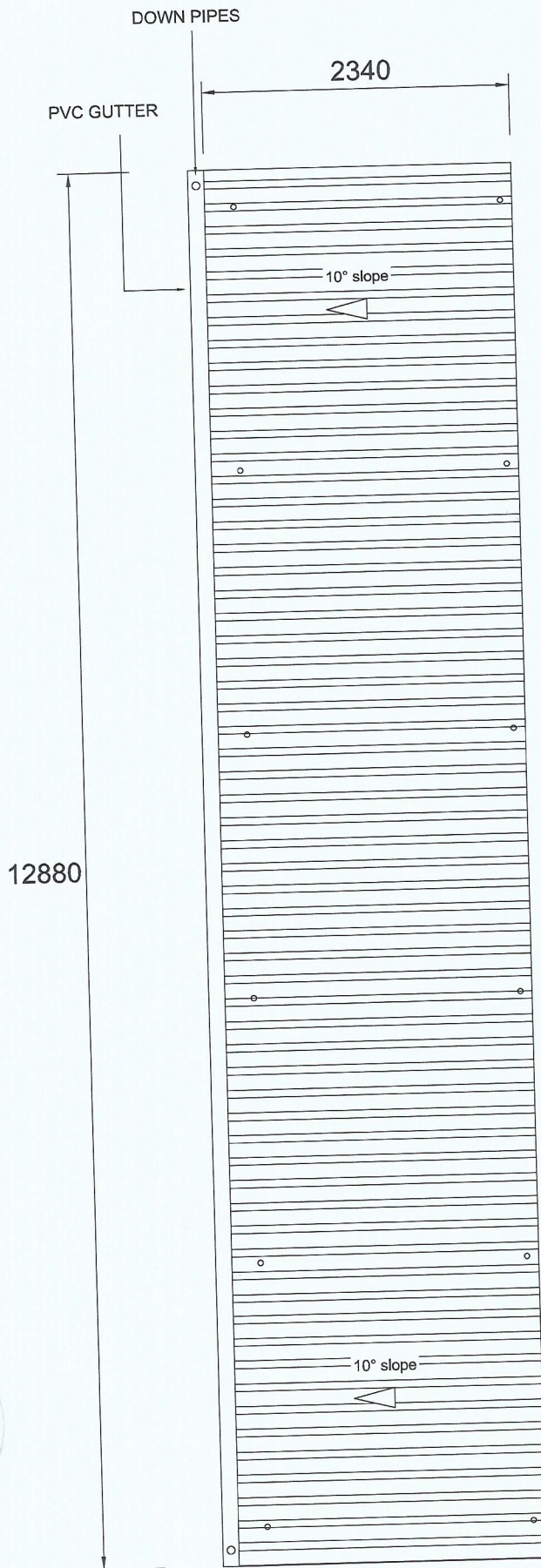

ROOF PLAN OVER WATER TANKS
PRESCHOOL SITE

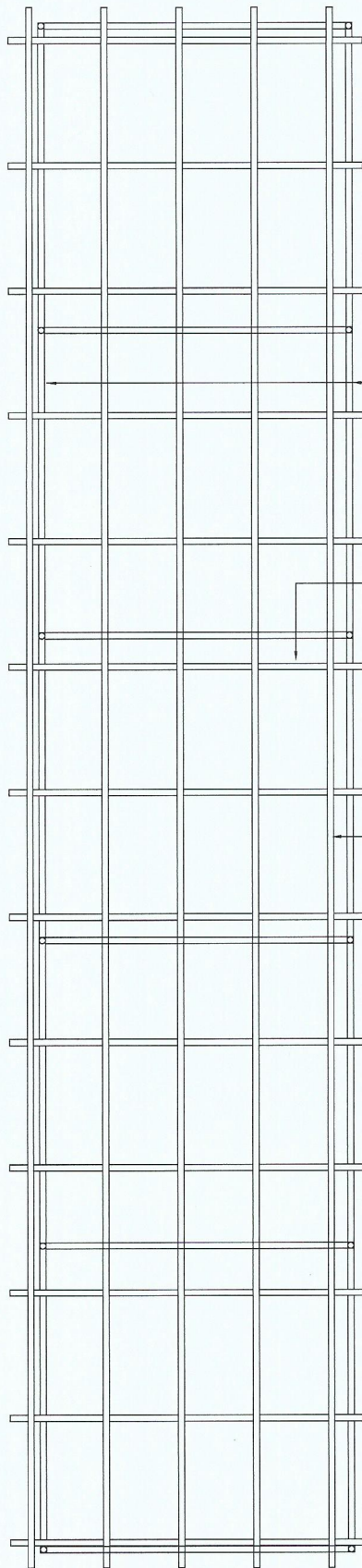

50mm \varnothing G.I pipe
between frames

100x50 Timber
rafters @ 1000 c/c

50x38 Timber
battens @ 600c/c

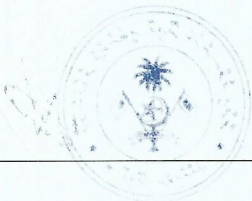

ROOF FRAMING PLAN
PRESCHOOL SITE



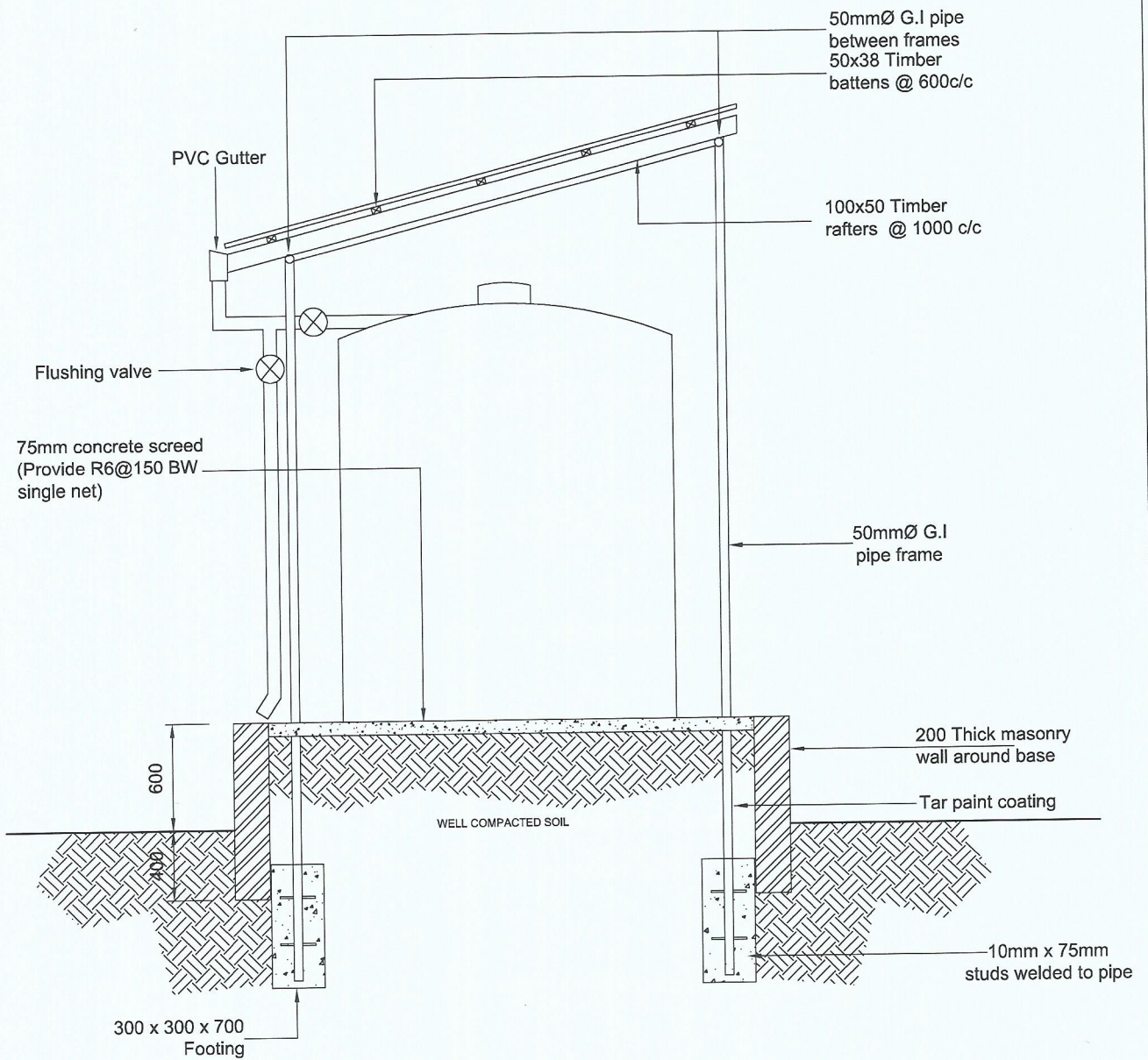

SECTION
PRESCHOOL SITE



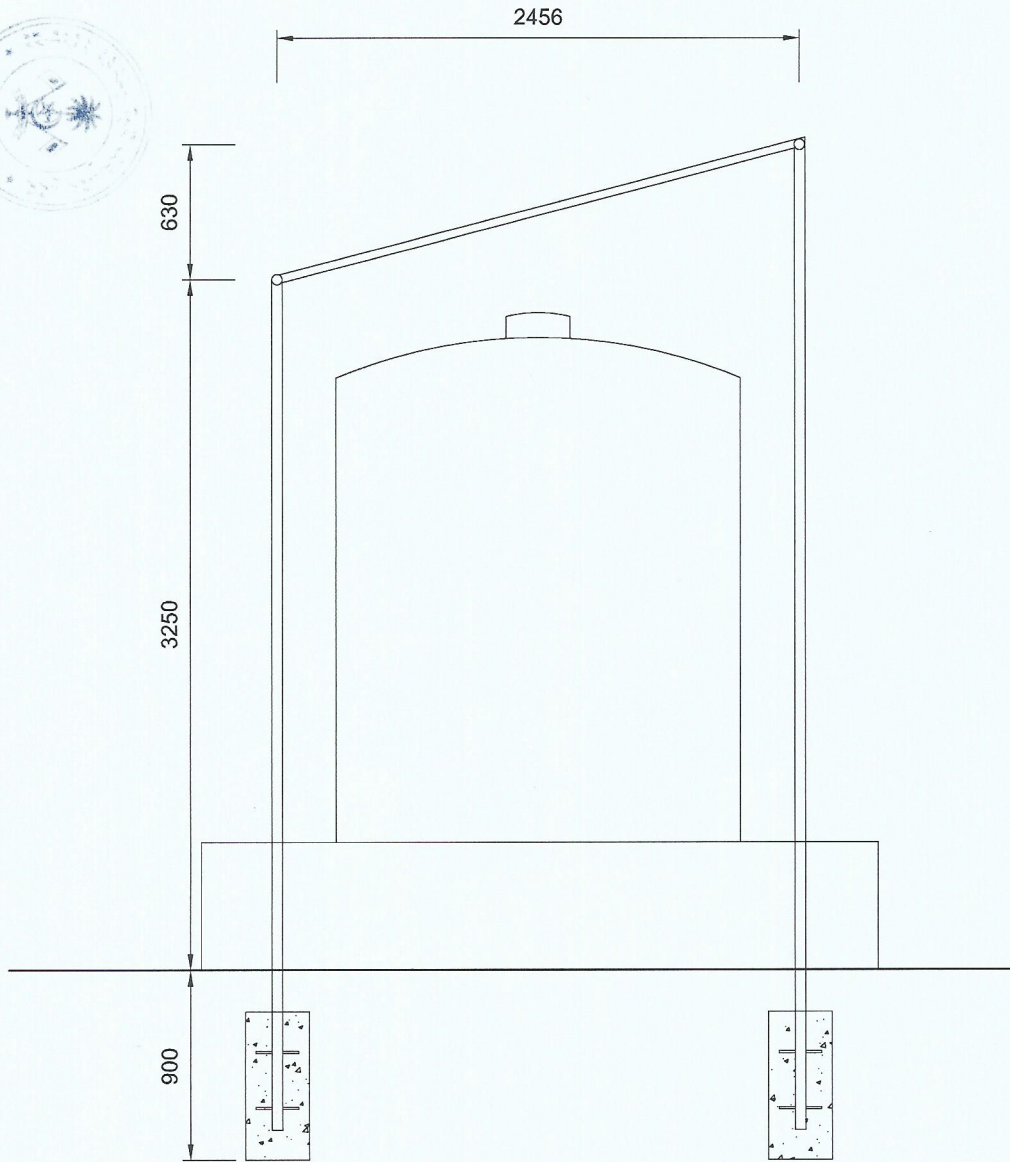
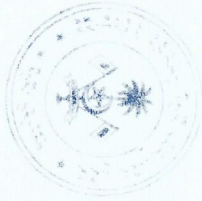

ROOF SUPPORTING FRAME DETAIL
PRESCHOOL SITE

- 50mmØ G.I pipe frames
- All welds are 5mm fillet welds



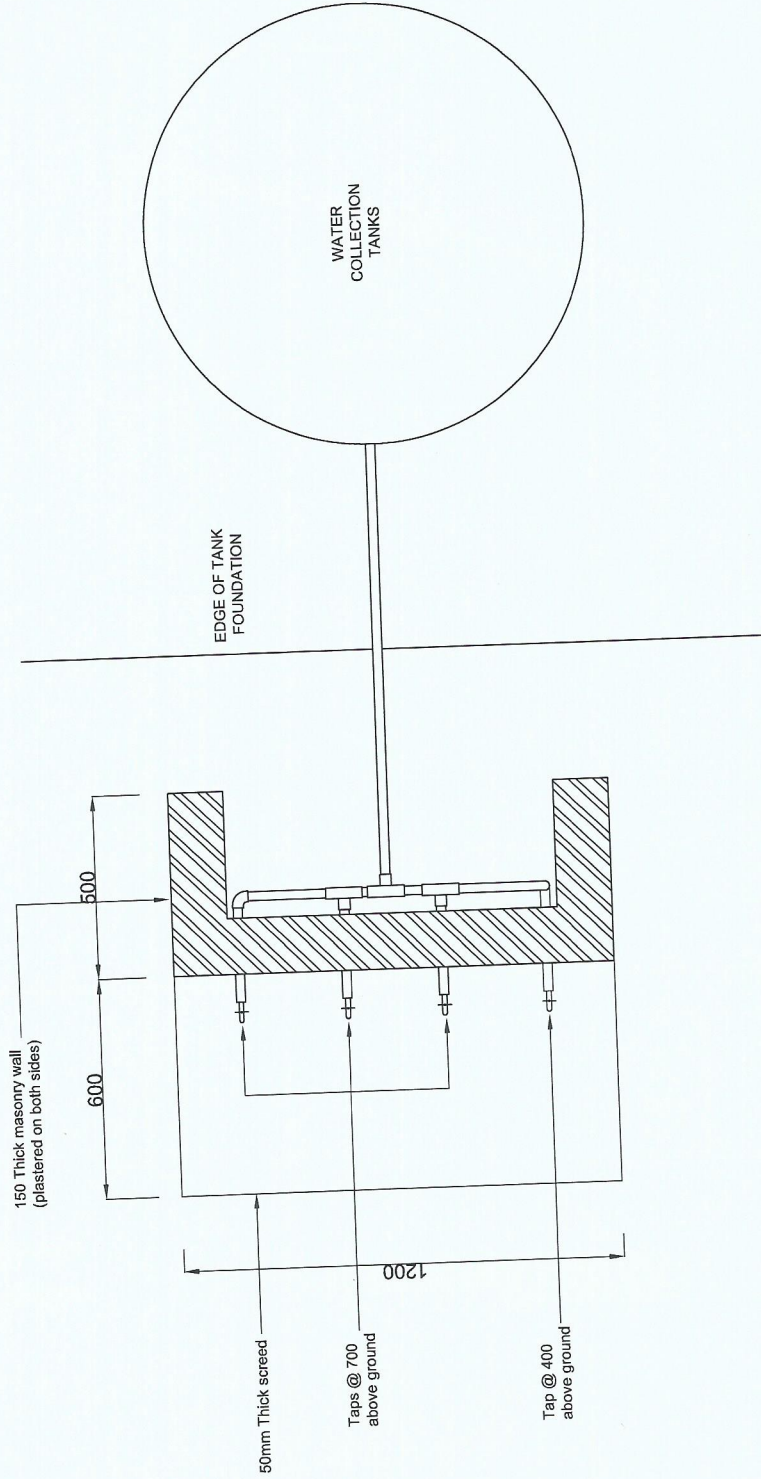
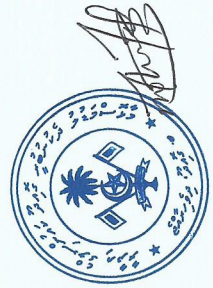

WATER DISTRIBUTION TAPPING STATION
PLAN



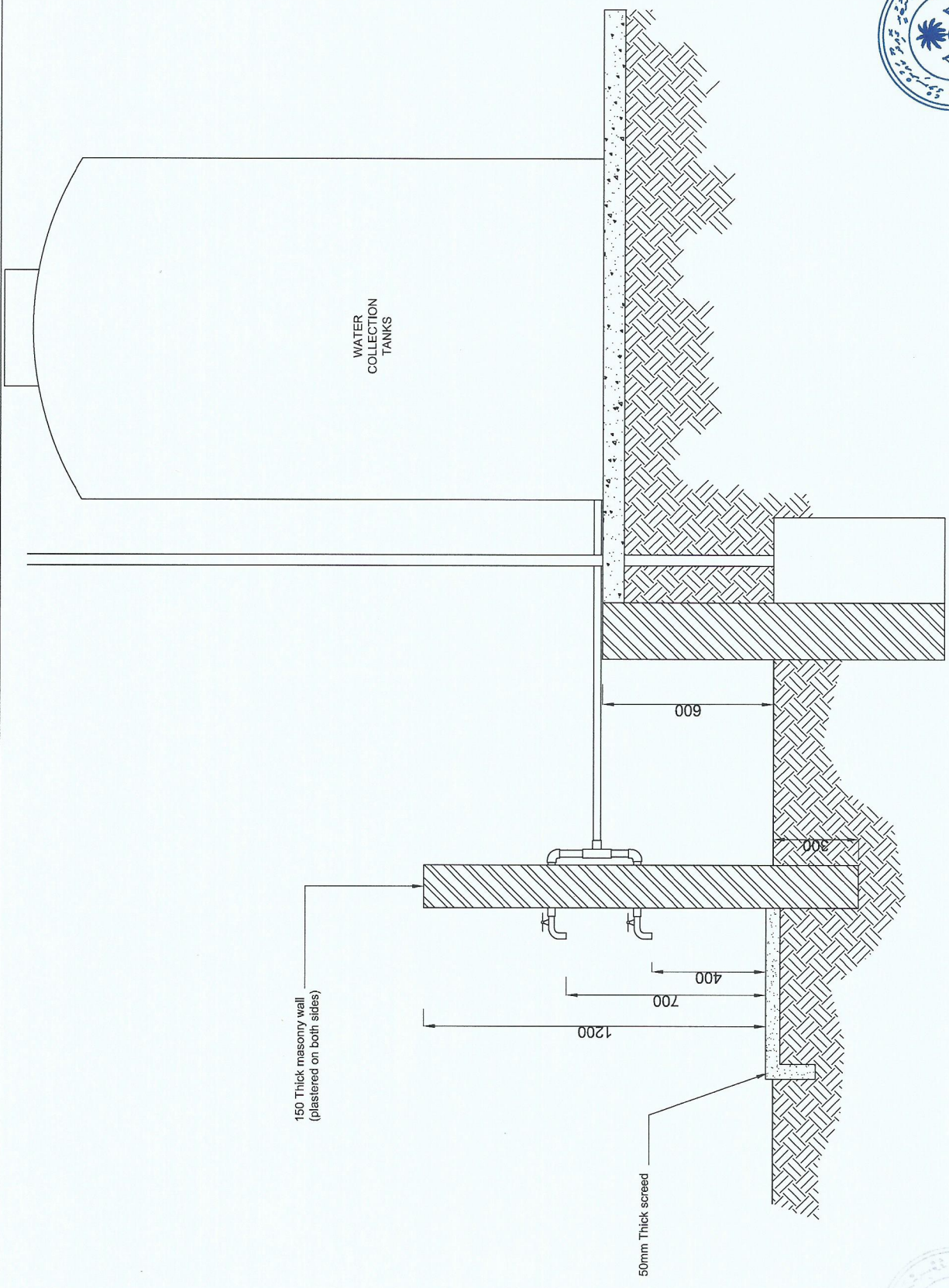
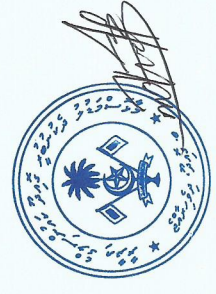

WATER DISTRIBUTION TAPPING STATION
SECTION

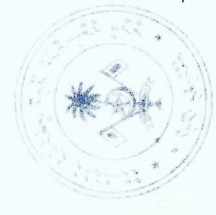



WATER TANK ARRANGEMENT - PLAN
COUNCIL SITE

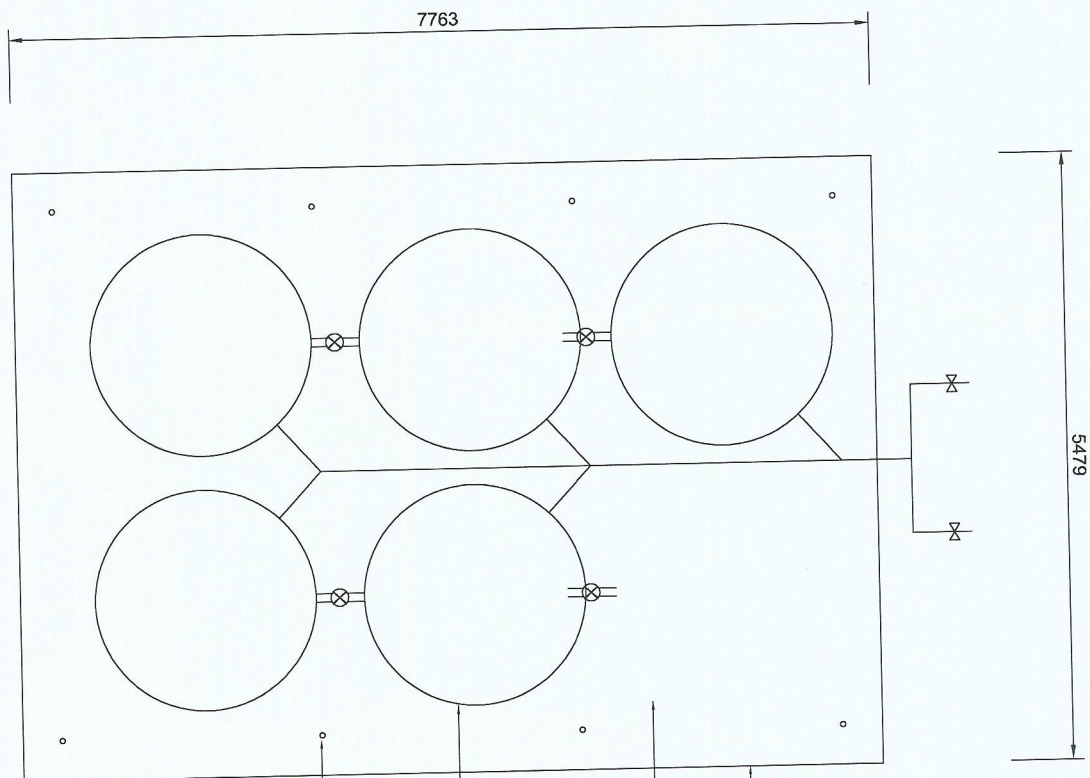

- Roof supporting frame pipes
- ⊗ Connecting pipes (at top of tank)
- X — Taps
- Roof supporting pipes
- New tanks (5k l)
- 75mm concrete screed (provide RS@150 BW single net)
- New foundation for tanks



[Handwritten signature]

ROOF SUPPORTING PIPE ARRANGEMENT - PLAN
COUNCIL SITE

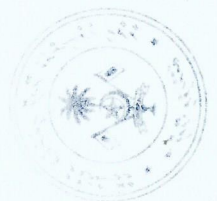
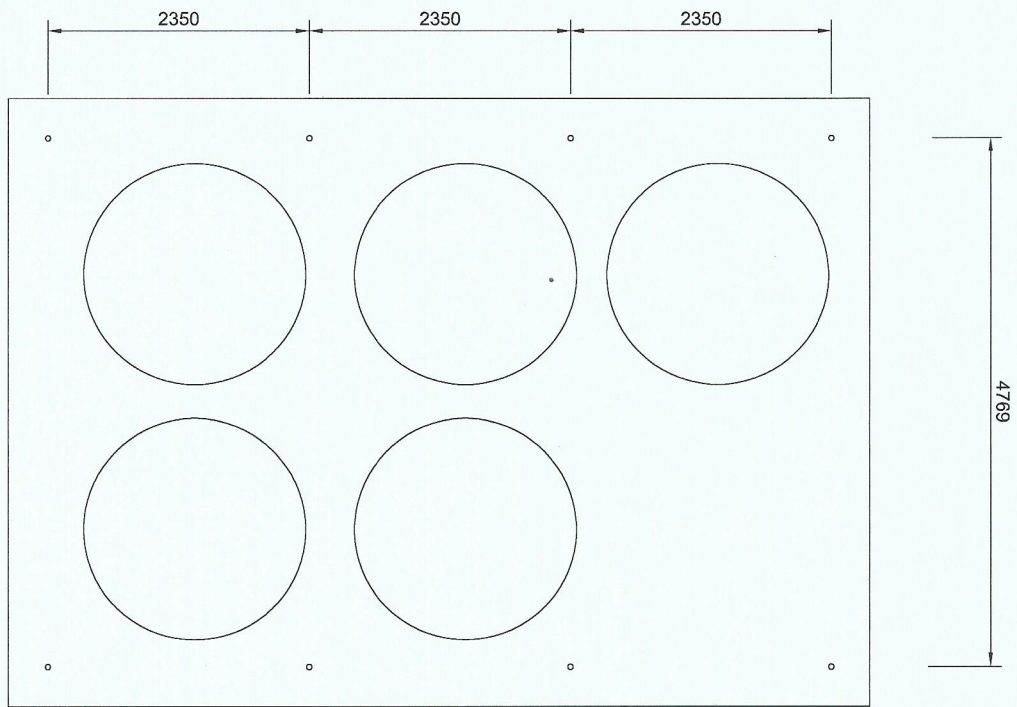



ROOF PLAN OVER WATER TANKS
COUNCIL SITE

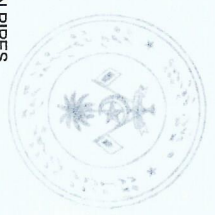

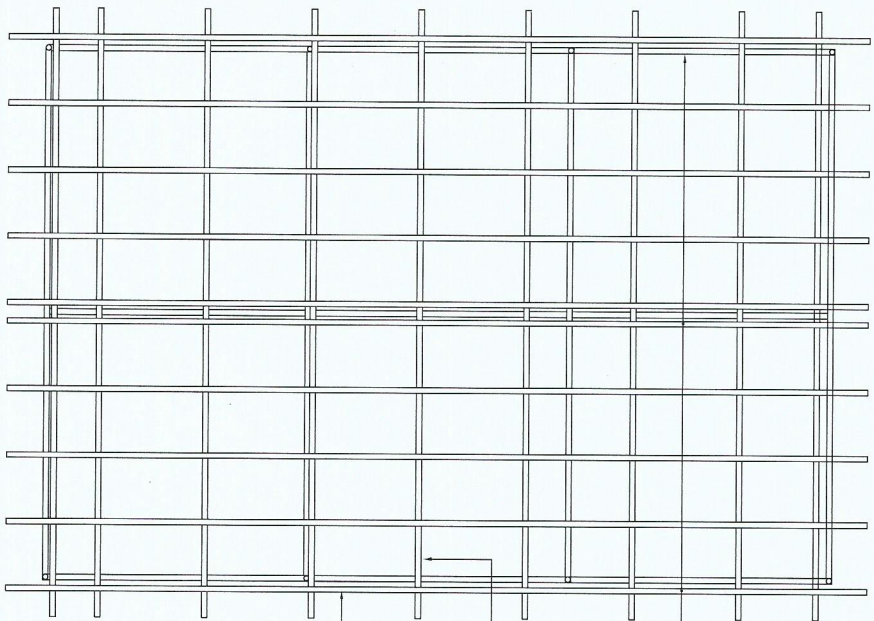

50mmØ G.I pipe
between frames

100x50 Timber
rafters @ 1000 c/c

50x38 Timber
battens @ 600 c/c

ROOF FRAMING PLAN
COUNCIL SITE



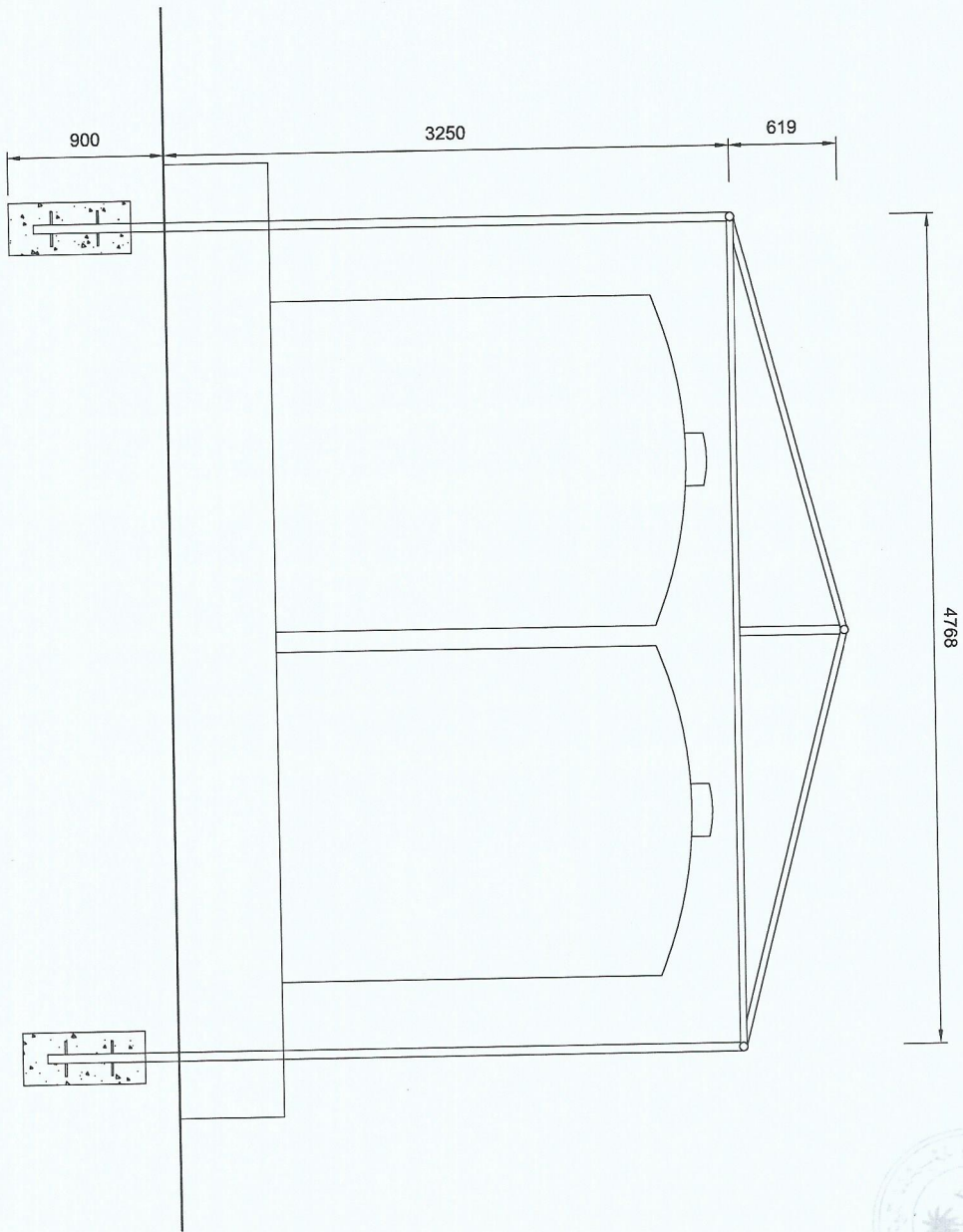

ROOF SUPPORTING FRAME DETAIL
COUNCIL SITE

- 50mmØ G.I pipe frames
- All welds are 5mm fillet welds



[Handwritten signature]



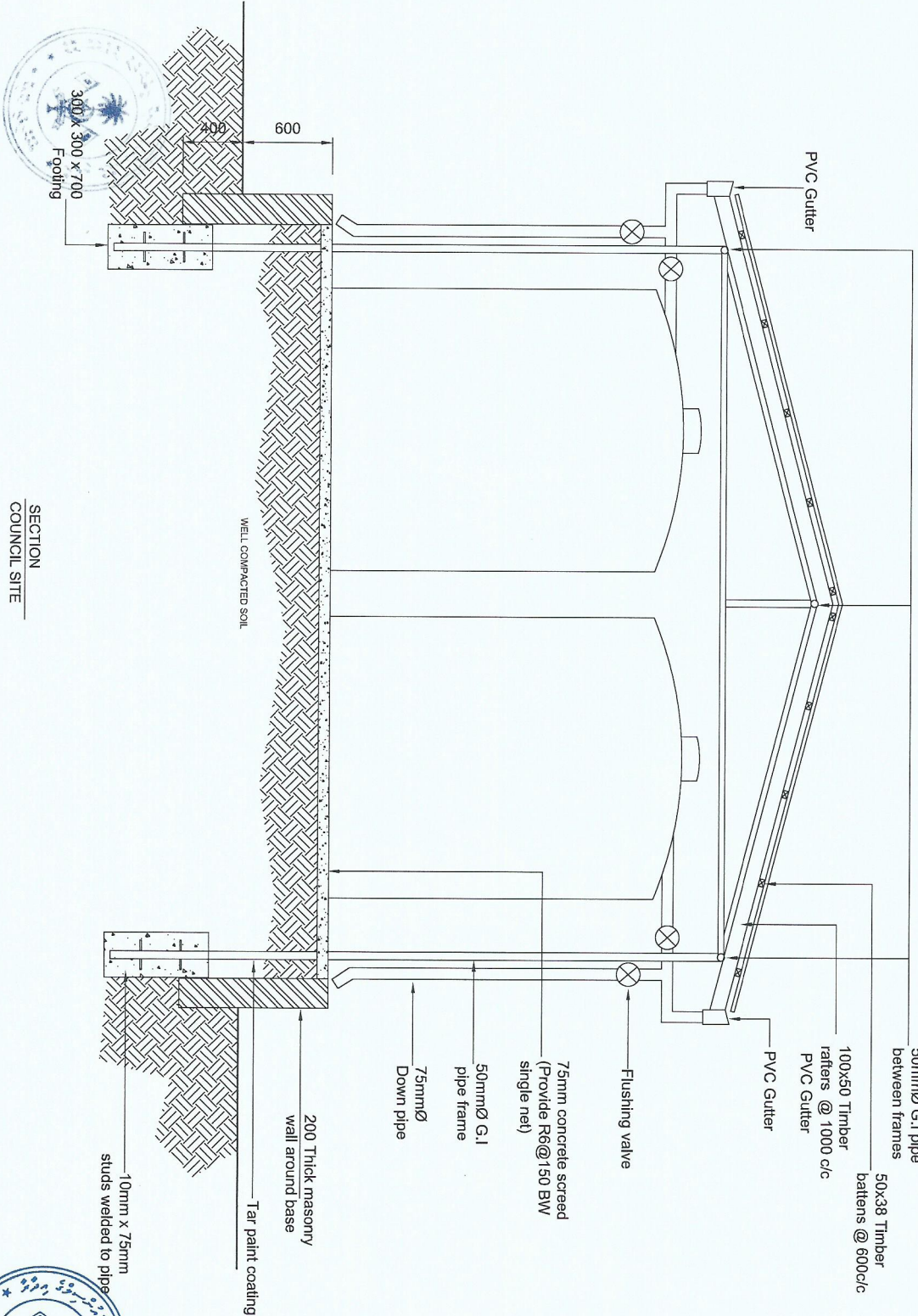

SECTION
COUNCIL SITE

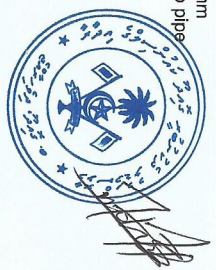

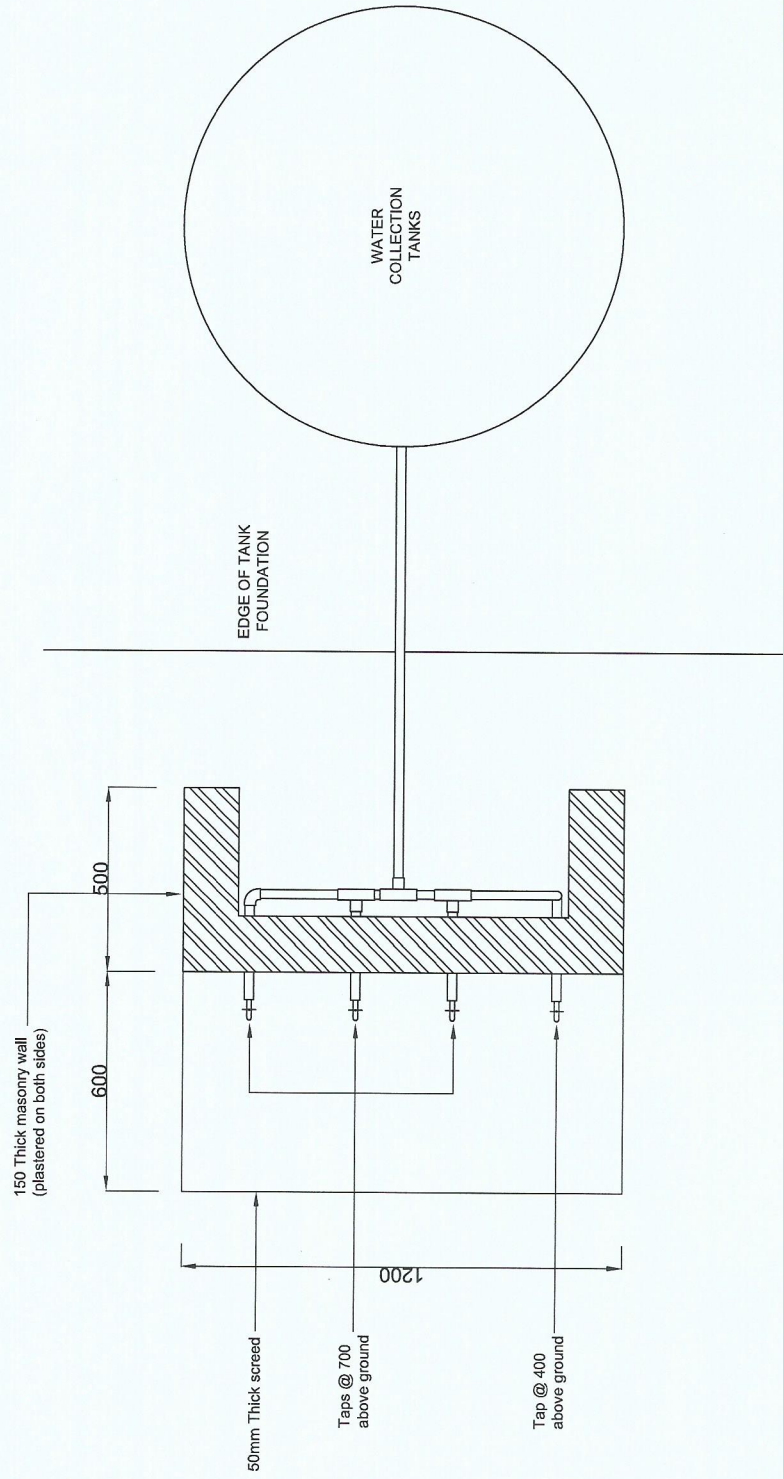
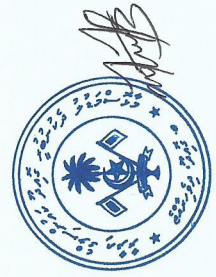

WATER DISTRIBUTION TAPPING STATION
PLAN



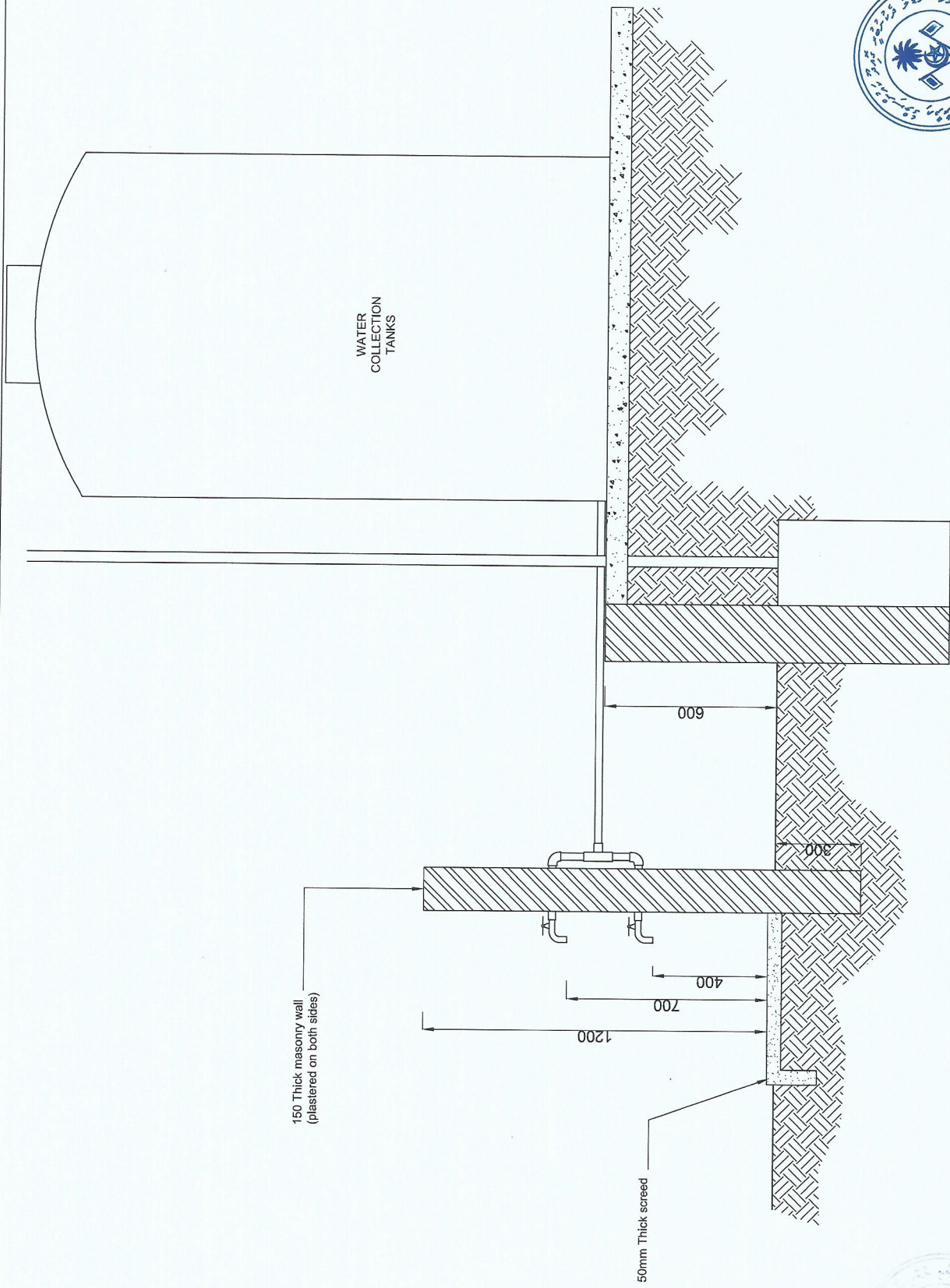
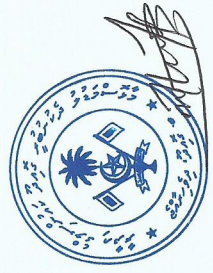

WATER DISTRIBUTION TAPPING STATION
SECTION

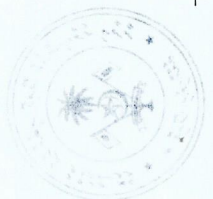

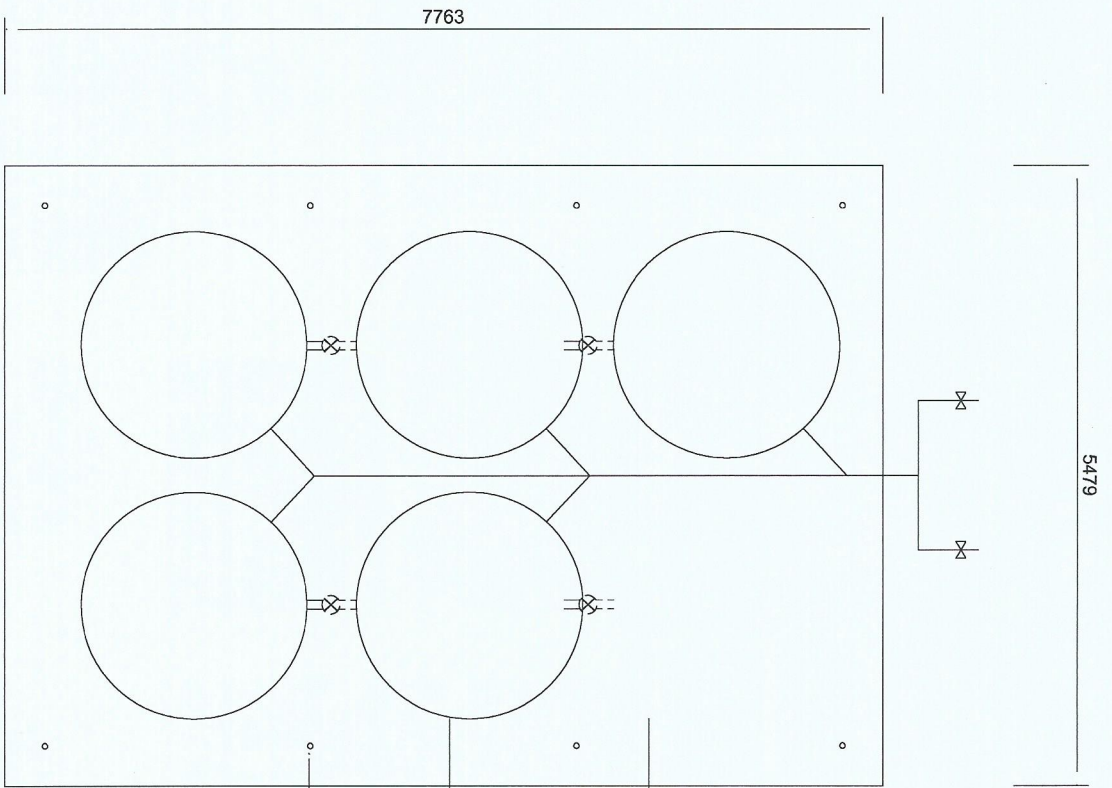

- Roof supporting frame pipes
- Connecting pipes (at top of tank)
- X Taps
- Roof supporting pipes
- New tanks (5k L)
- 75mm concrete screed (Provide Re@150 BW single rail)
- New foundation for tanks

WATER TANK ARRANGEMENT - PLAN
MASJIDUL HIDHAAYAA SITE



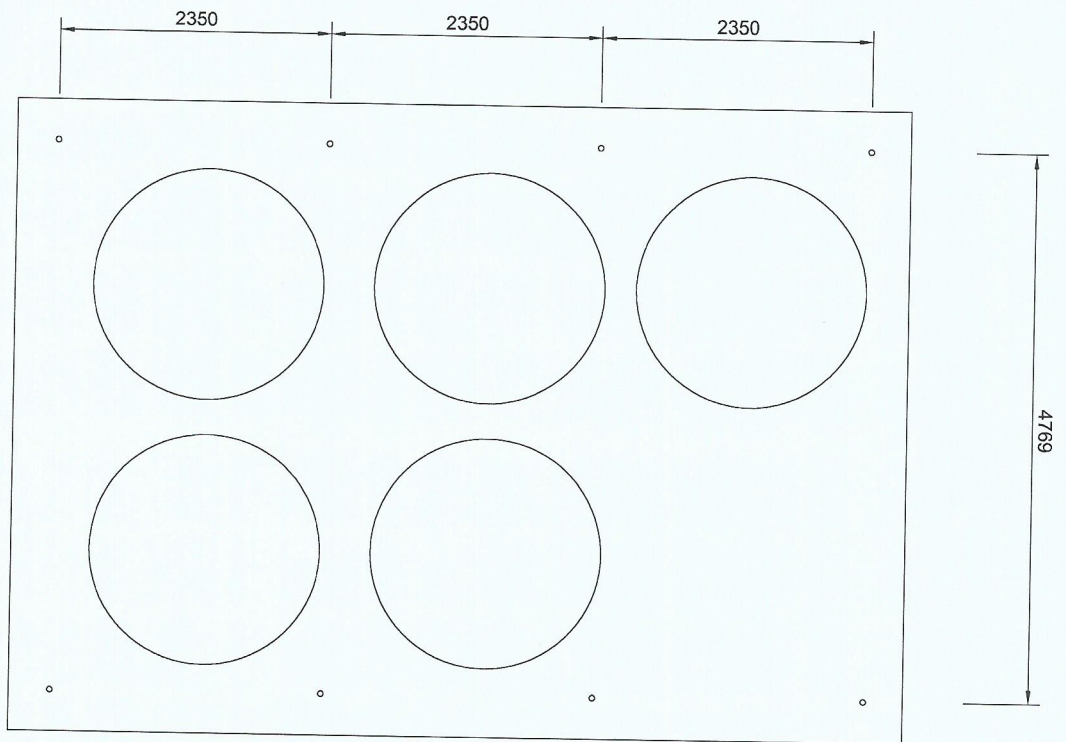

ROOF SUPPORTING PIPE ARRANGEMENT - PLAN
MASJIDUL HIDHAYAASITE



[Handwritten signature]

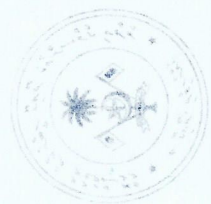

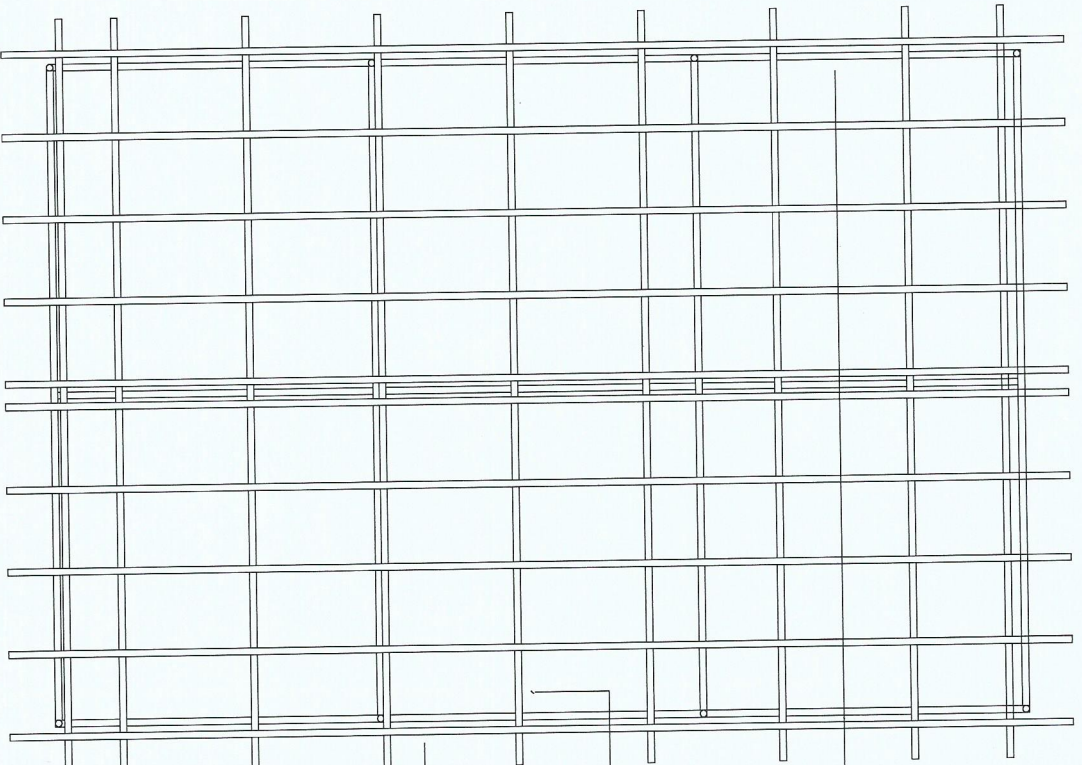

50mm Ø G.I pipe
between frames

100x50 Timber
rafters @ 1000 c/c

50x38 Timber
battens @ 600 c/c

ROOF FRAMING PLAN
MASJIDUL HIDHAAYAA SITE



5480

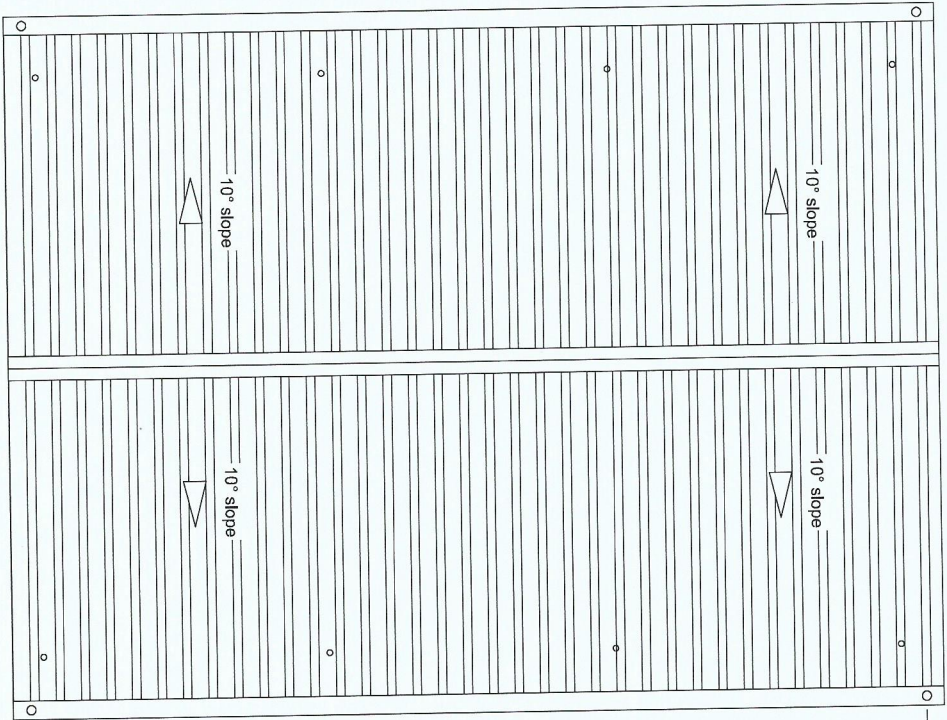

DOWN PIPES

PVC GUTTER

ROOF PLAN OVER WATER TANKS
MASJIDUL HIDHAAYAA SITE

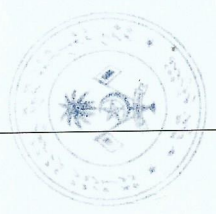

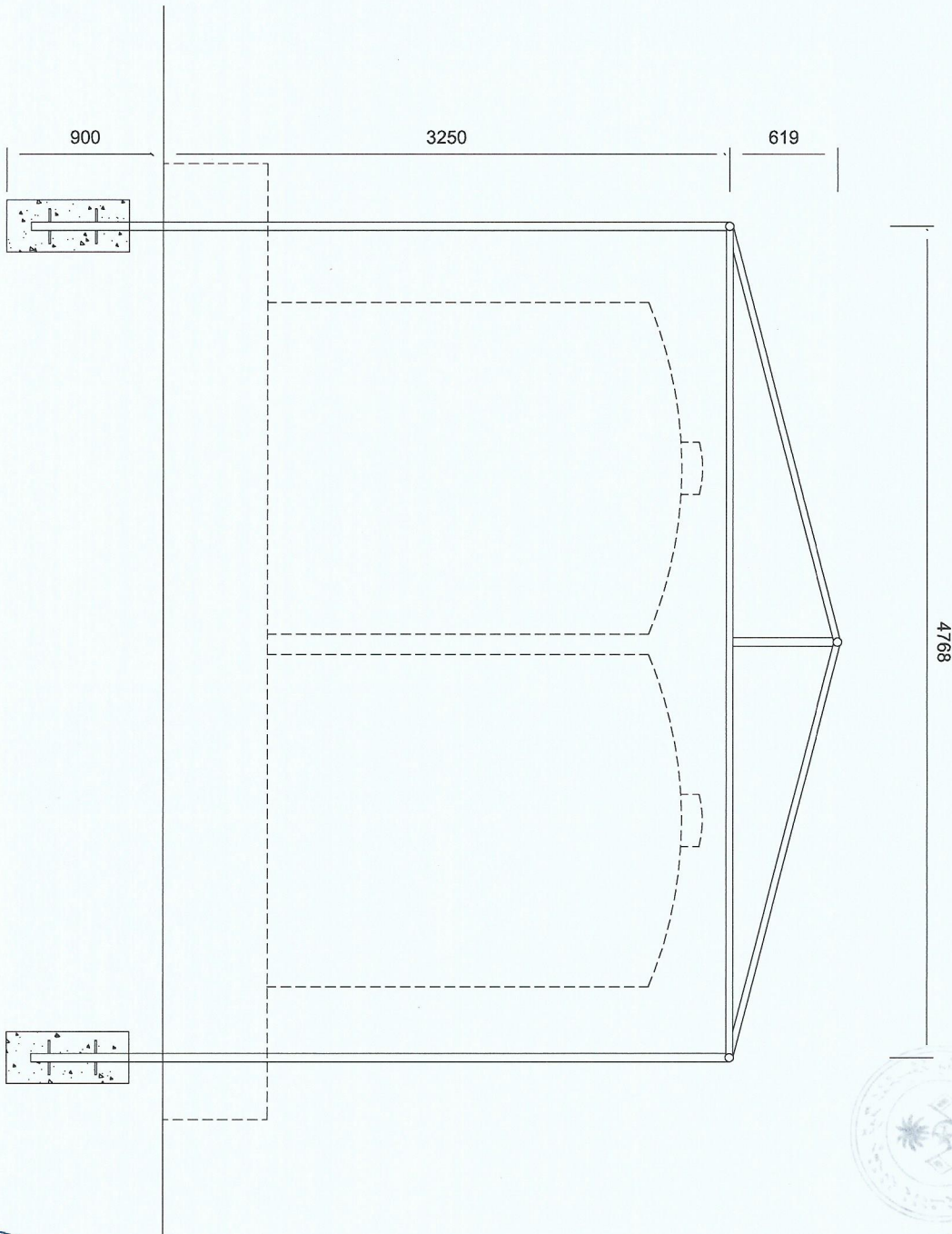

ROOF SUPPORTING FRAME DETAIL
 MASJIDUL HIDHAAYAA SITE

- 50mmØ G.I pipe frames
 - All welds are 5mm fillet welds

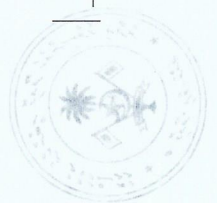

300 x 300 x 700 Footing

400 600

PVC Gutter

WELL COMPACTED SOIL

SECTION
MASJIDUL HIDHAAYAA SITE

200 Thick masonry wall around base
Tar paint coating
10mm x 75mm studs welded to pipe

50mmØ G.I pipe between frames
50x38 Timber battens @ 600c/c
100x50 Timber rafters @ 1000 c/c
PVC Gutter
PVC Gutter
Flushing valve
75mm concrete screed (Provide R6@150 BW single net)
50mmØ G.I pipe frame
75mmØ Down pipe



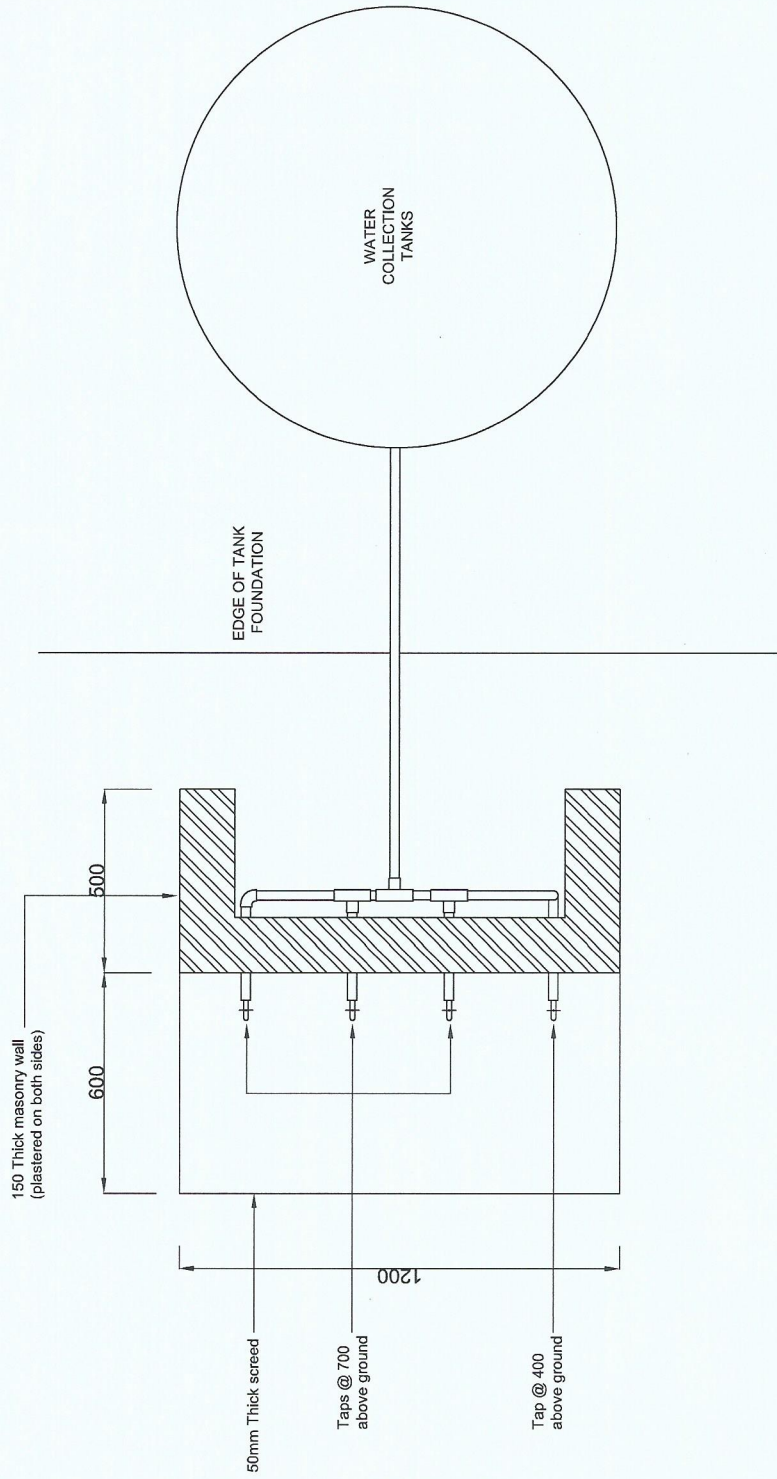

WATER DISTRIBUTION TAPPING STATION
PLAN



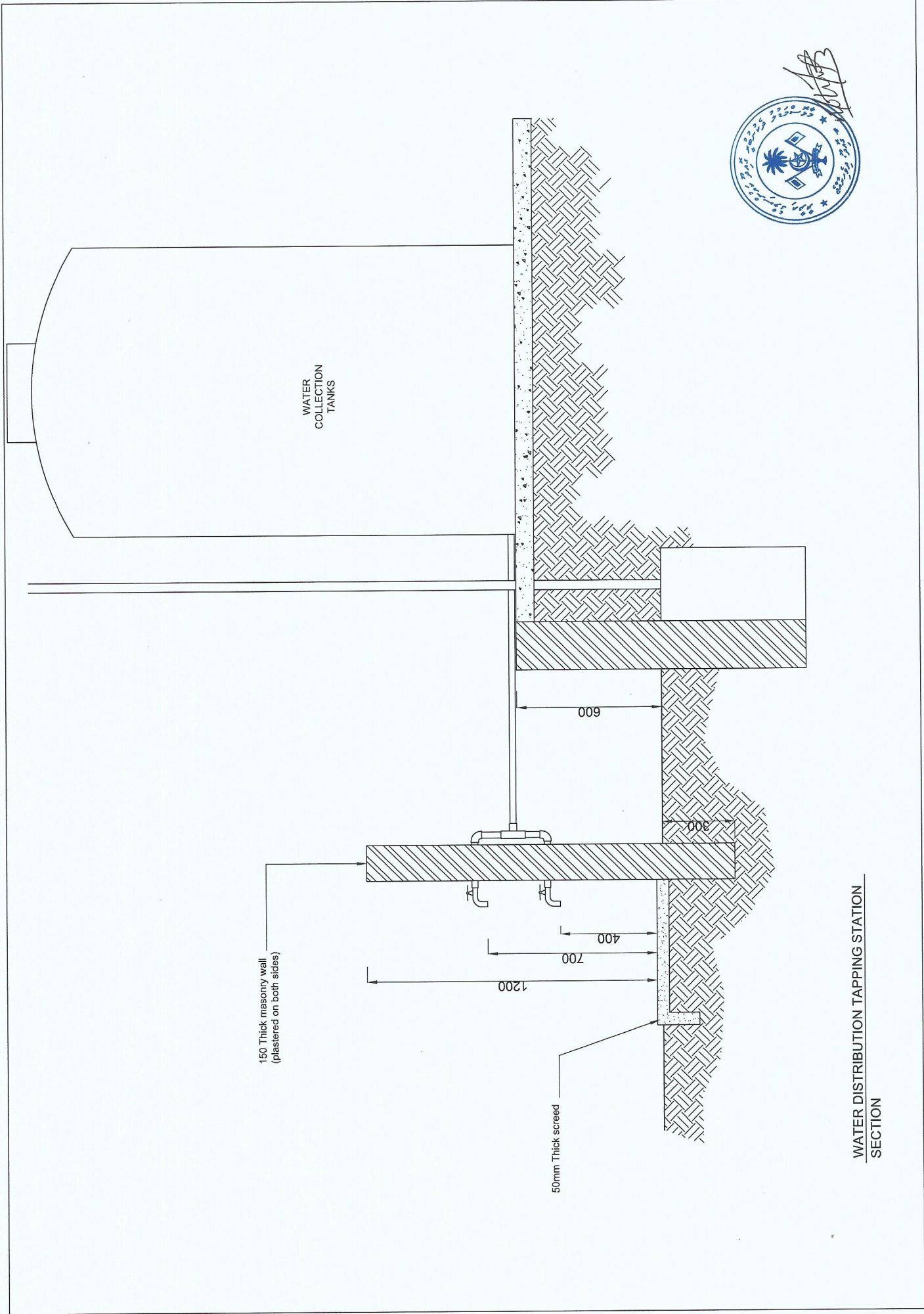

WATER
COLLECTION
TANKS

150 Thick masonry wall
(plastered on both sides)

50mm Thick screed

600

300

400

700

1200



WATER DISTRIBUTION TAPPING STATION
SECTION